

File Copy

GREENVILLE COUNTY POTENTIAL FLOOD DAMAGE ASSESSMENT

Prepared for the U.S.D.A. Soil Conservation Service by George S. Saussy III
working under contract with the S.C. Water Resources Commission.

South Carolina Water Resources Commission
3830 Forest Drive
P.O. Box 4440
Columbia, South Carolina

March 1985

TABLE OF CONTENTS

	PAGE
Summary of results.....	1
Workplan.....	6
Flood damage assessment parameters.....	8
How to use Field Survey Sheets.....	16
Appendix.....	19
Basin location map.....	20
Field Survey Sheets.....	21

LIST OF FIGURES

	PAGE
Figure 1. Survey Sheet Format.....	9
Figure 2. Sample Survey Sheet.....	17

LIST OF TABLE

	PAGE
Table 1. Flood Damage Assessment Summary.....	2
Table 2. Rank Order: Potential Flood Damage Areas.....	4
Table 3. Flood Damage Estimates.....	14
Table 4. Adjustment Factors.....	15

NOTE: Flood Insurance Rate Maps and Floodway Boundary Maps showing location of structures are separately bundled.

SUMMARY OF RESULTS

All accessible 100 year flood zones in Greenville County were investigated by windshield survey during the months of December 1984, January, February and March 1985. Structures at hazard were evaluated and a potential flood damage dollar-amount was calculated for each structure or group of similar structures. These results are contained in the Appendix. Table 1 provides a summary of the potential damage by tributary/reach. Table 2 rank orders these areas by a formula to identify the major areas at hazard.

The area with the highest potential damage monetarily is the Reedy River between Willard Street and Academy Street (\$3,343,200). The damage is primarily to warehouses and light industry. Most of the Reedy River has been studied in depth by a Corps of Engineers study: Flood Plain Information, Reedy River (April, 1972).

The second highest potential damage area is Brushy Creek (Enoree River basin) (\$900,200 for four reaches). This area contains 185 single family dwelling units at hazard. This creek has been studied in depth by a Corps of Engineers study: Detailed Project Report, Brushy Creek, (May, 1982).

The third major hazard area is the Langston Creek tributary running adjacent to Langston Street (FIRM Map # 145 and 145A). Damage to 79 single family dwelling units and mobile homes was estimated at \$342,000.

Table 1: Greenville County Flood Damage Assessment Summary

Basin	River	Tributary/Reach	Map #	# of Structures	\$ Damage
109-020	South Saluda	Table Rock	75 & 100	8	104,800
109-020	Middle Saluda	Jones Gap/Gap Creek	25	9	92,200
109-020	Middle Saluda	Gap Creek to confluence	100	17	125,300
109-010	North Saluda	Callahan Road to confluence	25 & 100	10	49,600
109-010	Saluda	Armstrong Creek	130	3	11,200
109-010	Saluda	Piedmont	250	3	5,890
109-100	Reedy	Langston Creek Trib.	145A	79	342,000
109-100	Reedy	Langston Creek Confluence	145	2	30,000+
109-100	Reedy	Little Creek	145	17	97,300
109-100	Reedy	Jones Cir to Sulphur Springs Rd.	145C	5	8,350
109-100	Reedy	Long Branch	145	17	46,100
109-100	Reedy	Brushy Creek	185	26	75,300
109-100	Reedy	Stallings Br. Road	215	1	1,650
109-100	Reedy	Richland #5	2	23	237,950
109-100	Reedy	Willard St. - Academy St.	4A	47	3,343,200
109-100	Reedy	Academy St. to Main St.	5A	1	100,000
109-100	Reedy	Richland Creek to confluence	5	7	13,450
109-100	Reedy	US29 & Scarlett Street	8	7	31,450
109-100	Reedy	Reedy River Trib. #2	8 & 9	5	75,800
109-100	Reedy	Rock Creek	Simpsonville	23	67,250
108-010	Enoree	Mountain Creek	155	19	124,250
108-010	Enoree	Cane Creek & Trib.	155 & 165	12	61,250
108-010	Enoree	Suber Rd. to Co. Line	170	1	3,200

Table 1. Continued:

Basin	River	Tributary/Reach	Map #	# of Structures	\$ Damage
108-010	Enoree	Rocky Creek	165	4	45,450
108-010	Enoree	Brushy Creek Fairfield L.	165	37	189,950
108-010	Enoree	Brushy Creek Hudson	165A	43	287,250
108-010	Enoree	Brushy Creek Marchant	165B	31	155,300
108-010	Enoree	Brushy Creek Kenllworth	165C	34	267,700
108-010	Enoree	Horsepen Creek	Simpsonville	5	18,550
108-010	Enoree	Gilder Creek	Mauldin	30	92,950
107-010	South Tyger	Hwy. 14	160	2	16,550

Table 2. Rank Order: Potential Flood Damage Areas

Tributary/Reach	Map #	Damage Factor
Willard St.-Academy St.	4A	157
Brushy Creek (Enoree)	165, 165 (A, BC)	33
Langston Creek Trib.	145A	27
Richland Creek #5	2	5.5
Gilder Creek	Mauldin	2.8
Mountain Creek	155	2.4
Gap Creek	100	2.1
Brushy Creek (Reedy)	185	2.0
Little Creek	145	1.7
Rock Creek	Simpsonville	1.6
Table Rock	75 & 100	0.8
Jones Gap/Gap Creek	25	0.8
Long Branch	145	0.8
Cane Creek	155 & 165	0.7
North Saluda	25 & 100	0.5
Reedy Trib. (Scarlet St.)	8	0.2
Rock Creek	165	0.2
Reedy (Academy St. to Main St.)	5A	0.1
All others less than 0.1		

Damage Factor = (# of structures X \$ Damage)/100,000

The fourth major hazard area is Richland Creek tributary #5 between Mohawk Drive and Townes Street. Twenty three single family dwelling units were estimated at \$237,950.

WORKPLAN

GREENVILLE COUNTY POTENTIAL FLOOD DAMAGE ASSESSMENT

Purpose:

To identify and assess potential damage to structures located within or adjacent to the 100-year Flood Boundaries throughout Greenville County, South Carolina.

Preliminary Preparations:

1. Discuss methodology and end-producer with USDA Soil Conservation Service and South Carolina Water Resources Commission.
2. Collect and cross-reference study maps.
3. Develop forms and methodology for study.
4. Make preliminary reconnaissance of study area.

Workplan:

1. Survey all Flood Hazard areas in Greenville County visually accessible by vehicle.
 - a. Identify structures within the 100-year Flood Boundary as shown on FIRM or Floodway maps.
 - b. Evaluate structure characteristics, (adopted from SCS Technical Guide #21).
 - c. Estimate 100-year Flood level in relation to 1st floor level of the structure using hand level.

- d. Assess potential damage to structures using tables adapted from SCS Technical Guide #21.

2. Survey Time Phasing.

- a. Study area will be surveyed one FIRM or Floodway map panel at a time
- b. As panel (areas) are completed, data will be written up and turned into SCWRC in draft form
- c. Status reports will be turned into SCWRC once every two weeks, including work completed and work expected to be completed in the succeeding two weeks
- d. Quality control sampling will be conducted by SCWRC personnel as and when considered necessary
- e. A Final Report of the study including maps, data sheets, tables and summary will be completed before March 22, 1985--tables will list and summarize potential damage assessments by hydrologic basins and stream segments and will consist of reference numbers to location of structures on FIRM or Floodway maps, characteristics of the structure depth of 100-year flood levels in relation to 1st flood levels of the structures and estimated potential damage to structures

FLOOD DAMAGE ASSESSMENT PARAMETERS

RESIDENTIAL AND COMMERCIAL PROPERTY

Methodology:

A methodology was developed based on Floodway Damage Estimates Residential and Commercial Property, EWP Technical Guide No. 21 Supplement 1, (Fort Worth: South Regional Technical Service Center, USDA, SCS, December 1970).

Description Parameters were modified to reflect current increased values and more recent construction factors.

A field inventory worksheet, "Field Inventory of Property in Flood Area" (Fig. 1) is used to establish estimates of damages from updated damage data (Table 3).

The property classification parameters for the "Field Inventory" are as follows:

1. Type of Property:

Residential property

RFS - Frame, Stucco

RBV - Brick Veneer

RM - Masonary

MH - Mobile Home

Figure 1. Survey sheet format.

County Flood Area Property Inventory

Basin # _____ River _____ Tributary/Reach _____

FIRM/Floodway panel # _____ Date Surveyed _____

Structure # (Refer to map)	100 yr. Flood Elevation in reference to 1st Floor (in feet)	TYPE	CLASS	Stories	Basement?	Size	Furnishing Class	Yard Damage or Bus. Type	Estimated Damage
-------------------------------	---	------	-------	---------	-----------	------	------------------	--------------------------	------------------

Commercial property

Classified by size and business type

Com, Size, Type

2. Class - structures are classified by value

Residential

Class "C" - less than \$50,000

Class "B" - \$50,000 to \$99,000

Class "A" - more than \$100,000

Mobile Homes

Class "MH" - Double wide 24 x 50 - \$24,400

Extra long - 14 x 70 - \$21,560

Long - 12 x 60 - \$12,200

Small - 55 - \$8,000

3. Stories

Residences are classified as to the number of stories. The classifications included are one story, 1-1/2 stories, 2 stories, and split level houses. Each family unit of a semi-detached or duplex residence should be treated as a detached residence and appraised accordingly.

For other properties, include only that portion of the building used for commercial operations; a 2 story building with a store on the first floor and a residence on the second floor will be 1 story for the purpose of commercial appraisals.

For other properties than residential, this column may also be used to indicate wood flooring or concrete.

4. Basement

All buildings except mobile homes (Class MH) are classified as with or without basements.

5. Size

The size of a building is based on its plan area. However, due to the infinite number of building sizes, it is felt that sufficient accuracy can be achieved by using three basic sizes - small, average and large - for each type of residential building. Non residential buildings are sized by square dimensions, i.e. "20 x 30".

6. Yard Damage or Business Type

Additional damage to the building is calculated in terms of additional items that may be incurred in the building if flooded. Types of additional damage that may be included are listed below:

Yard damage	- \$ 300
Temporary evacuation cost	- \$ 500
Building Cleanup	- \$ 500
Damage to cars	- \$1000
Probability of car damage	- \$ 25
Other damage	- \$ 200

Total additional damage: $300+500+500+1000(0.25)+200 = \$1,750$

Source: Detailed Project Report, Brushy Creek, (May 1982, USA CORP)

The process of assessing yard damage was simplified for the purposes of this study by identifying three (3) levels of severity:

Minor damage:	\$ 500 or less
Moderate damage:	\$ 501 to \$1,000
Major damage:	\$1,001 to \$1,750

Minor damage implies damage to some landscaping and miscellaneous cleanup and replacement costs

Moderate damage implies more extensive damage to landscaping, fences, yard furniture and equipment

Major damage extensive yard and vehicle damage or damage to outbuildings

7. Furnishings

Furnishings are divided into three classifications: High, Average, and Low. The exterior appearance of a building is assumed to indicate the relative value of the furnishings within. Buildings which are old and in poor condition have a generally slovenly appearance and may be expected to contain furnishings of comparatively low value; whereas immaculately maintained properties probably contain furnishings of comparatively high value.

The following should be kept in mind when filling in the Appraisal Sheet. If necessary, break the properties into two or more separate establishments, such as, a motel with a large restaurant. Use as many additional lines as is necessary for remarks or explanations. Such additional data will facilitate office analysis.

The generalized damages shown in Table 3 are for average size residential buildings and contents with average furnishings based on the class of the residence, the number of stories, and if the residence has a basement.

Table 4 provides adjustment factors to be used to adjust the damages in Table 3 depending on the size of the buildings and the classification of the furnishings. The factor is the percentage above or below that listed in Table 3 for structures with other than average Class (B), size or furnishings.

Table 3. Flood Damage Estimates.

100 Years Flood Level in Reference to 1st Floor Level of Structure

Class	Stories	Base- ment	Size	Furnish- ings	1st																		
					-8	-7	-6	-5	-4	-3	-2	-1	0	+1	+2	+3	+4	+5	+6	+7	+8	+9	+10
A	1	Yes	Av	A	3.6	8.1	12.4	15.0	16.4	17.3	17.9	18.6	27.4	39.4	52.2	62.2	67.5	69.9	71.4	72.7	73.1	81.4	84.6
A	1	No	Av	A	-	-	-	-	-	.2	.5	.7	8.1	18.7	33.6	45.7	51.7	54.2	55.6	56.9	57.4	65.7	69.3
A	1 1/2	Yes	Av	A	2.9	6.7	10.2	11.9	12.6	13.5	14.1	14.8	21.0	30.0	38.8	46.0	49.6	51.7	53.2	54.4	54.9	61.8	66.7
A	1 1/2	No	Av	A	-	-	-	-	-	.2	.5	.7	5.5	13.1	23.9	33.2	37.6	39.8	41.3	42.4	42.9	49.9	54.7
A	2	Yes	Av	A	3.3	7.8	12.1	14.7	16.1	16.9	17.6	18.3	24.6	32.4	37.6	42.1	45.0	47.4	48.5	49.6	49.8	58.0	62.3
A	2	No	A	A	-	-	-	-	-	.2	.5	.7	5.6	12.1	19.3	25.9	29.5	32.0	33.1	34.2	34.4	42.5	46.9
B	1	Yes	A	A	-	1.5	2.6	3.6	4.8	5.6	6.2	6.8	11.6	19.8	27.7	34.6	37.8	39.3	40.5	41.5	41.9	47.5	49.5
B	1	No	A	A	-	-	-	-	-	.1	.2	.3	5.2	11.9	20.5	28.1	31.7	33.2	34.4	35.4	35.8	41.3	43.7
B	1 1/2	Yes	A	A	-	1.1	1.9	2.9	3.4	3.8	4.1	4.7	8.2	14.5	20.6	26.2	28.5	29.9	31.0	32.0	32.2	37.6	39.9
B	1 1/2	No	A	A	-	-	-	-	-	.1	.2	.3	3.8	8.7	15.4	21.7	24.5	25.9	26.9	27.9	28.2	33.6	35.8
B	2	Yes	A	A	-	1.5	2.8	4.1	5.1	5.9	6.3	6.6	9.9	15.4	19.4	22.8	24.7	26.0	27.0	27.7	27.8	33.2	36.1
B	2	No	A	A	-	-	-	-	-	.1	.2	.3	3.7	7.8	12.4	16.4	18.9	20.1	21.2	21.9	22.0	27.4	30.2
C	1	Yes	A	A	-	-	.7	1.2	1.6	2.4	2.8	3.0	4.9	7.0	9.7	11.7	13.8	14.4	14.8	15.2	15.3	17.6	18.4
C	1	No	A	A	-	-	-	-	-	.1	.2	.2	2.9	4.6	7.5	9.8	12.3	12.9	13.3	13.7	13.8	16.1	17.0
C	1 1/2	Yes	A	A	-	-	.7	1.2	1.6	2.4	2.8	3.0	4.9	7.0	8.9	10.6	12.0	12.5	13.0	13.5	13.6	16.6	18.3
C	1 1/2	No	A	A	-	-	-	-	-	.1	.2	.2	2.9	4.2	6.7	8.6	10.5	11.0	11.5	12.0	12.1	15.1	16.8
C	2	Yes	A	A	-	-	.7	1.2	1.6	2.4	2.8	3.0	4.9	7.0	7.7	8.9	9.9	10.5	10.8	11.3	11.3	14.3	15.5
C	2	No	A	A	-	-	-	-	-	.1	.2	.2	2.9	3.7	5.5	6.9	8.4	8.9	9.3	9.7	9.8	12.8	15.5

¹In thousands of dollars

NOTE: Estimates based upon EWP Technical Guide No. 21 Supplement 1 Table #1A updated by Engineering News Report Factor of 4.6.

Table 3. Continued

100 Year Flood Level In Reference to 1st Flood Level

Class	Size	Form	-1	0	+1	+2	+3	+4	+5	+6	+7	+8	+9
MH	DW	A	.3	1.9	3.7	5.6	7.1	8.0	8.6	9.3	9.9	10.8	12.3
MH	XL	A	.3	1.6	3.2	4.8	6.3	6.9	7.5	8.0	8.5	9.3	10.7
MH	L	A	.3	.9	1.8	2.7	3.5	3.9	4.2	4.5	4.8	5.2	6.0
MH	M	A	.1	.5	1.2	1.9	2.4	2.9	3.25	3.6	3.9	4.3	4.3
MH	S	A											

MH values compared with ratio of damage to cost as standard house (+1 = .15 of average value) indexed by EWP Technical Guide No. 21 Supplement 1 Table #1A.

Table 4. Adjustment Factors

Class	Size	Furnishings	Factor (%)
A	L	H	130
A	L	A	111
A	L	L	95
A	A	H	117
A	A	A	100
A	A	L	84
A	S	H	106
A	S	A	90
A	S	L	74
B	L	H	134
B	L	A	120
B	L	L	106
B	A	H	114
B	A	A	100
B	A	L	86
B	S	H	91
B	S	A	78
B	S	L	67
C	L	H	154
C	L	A	121
C	L	L	88
C	A	H	135
C	A	A	100
C	A	L	70
C	S	H	110
C	S	A	79
C	S	L	57
MH	L	H	218
MH	L	A	120
MH	L	L	59
MH	A	H	169
MH	A	A	100
MH	A	L	43
MH	S	H	100
MH	S	A	80
MH	S	L	26

¹To adjust Table 3 damages for other than average size residences and furnishings.

HOW TO USE FIELD SURVEY SHEETS

Figure 2 is a sample of a Field Survey Sheet. It shows which hydrologic basin the tributary/reach lies in and indicates which firm/floodway map to refer to: in this case Greenville County Firm #155.

- Structure # refers to the number of the structure as located on the Firm/Floodway Map or a detail map.
- The number in parenthesis indicates the number of structures identified at that location if more than one.
- 100 year Flood level indicates the estimated level in feet of a 100 year flood in reference to the first flood of the structure - either above or below.
- -3 indicates that though there would be no structural damage to the structure, some level of yard damage would be expected, in this case "moderate".
- Type refers to the type of construction, in this case a residential Brick Veneer (RBV).
- Class - refers to the quality of construction.
- Stores - refers to the number of stores to the structure.

Figure 2. Sample survey sheet.

_____ County Flood Area Property Inventory

Basin # _____ River _____ Tributary/Reach _____

FIRM/Floodway panel # _____ Date Surveyed _____

Structure # (Refer to map)	100 yr. Flood Elevation in reference to 1st Floor (in feet)	TYPE	CLASS	Stories	Basement?	Size	Furnishing Class	Yard Damage or Bus. Type	Estimated Damage	
1 (3)	10	RBV	B	1½	No	A	A	Moderate	18,600	
2	<-3	NO STRUCTURAL DAMAGE							Moderate	1,000

SAMPLE

- Basement - indicates whether the structure has a basement or not.

- Size - refers to the square footage floor space of a structure, A being "Average" 1200 to 1500 square foot.

- Furnishing class refers to quality of furnishings which is usually considered to be A for "Average".

- Yard damage - estimate amount of damage to yard and outside equipment. Business type indicate the structures commercial use.

- Estimate damage is the estimated damage which might occur to the structure.

Appendix
Field Survey Sheets

BASIN LOCATION MAP

GREENVILLE COUNTY, S.C.

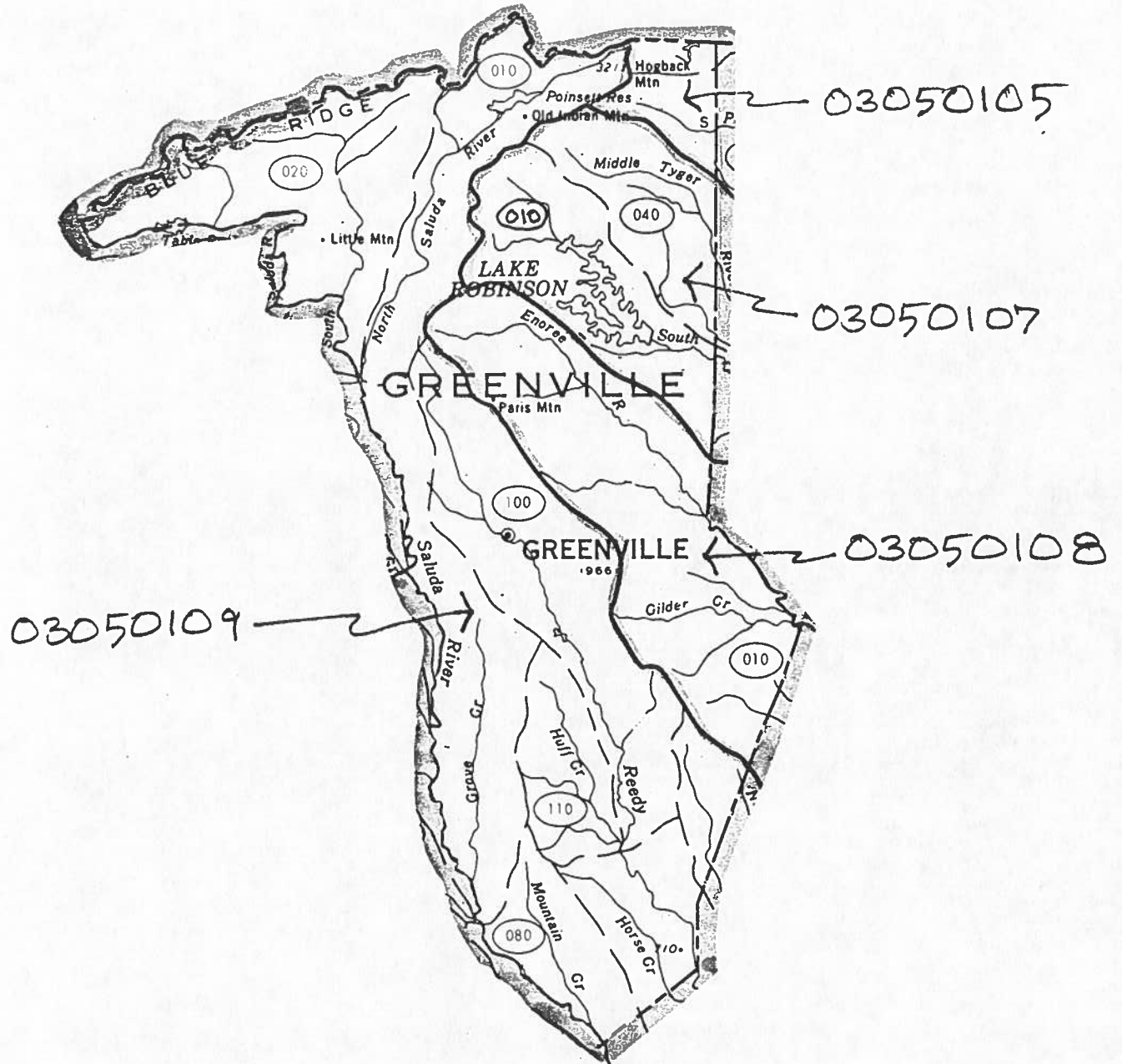

Greenville Co.

County Flood Area Property Inventory

Basin # 107-010

River South Tyger

Tributary/Reach HWY 14

FIRM/Floodway panel # Greenville Co. #160

Date Surveyed 2-9-85

Structure # (Refer to map)	100 yr. Flood Elevation in reference to 1st Floor (in feet)	TYPE	CLASS	Stories	Basement?	Size	Furnishing Class	Yard Damage or Bus. Type	Estimated Damage
1	+0	MH	n/a	1	no	DW	A	major	3,550
2	+0	Com	n/a	1½	no	(20x30)	restaurant	dining rm.	13,000
									16,550

Basin # 108-010

River Enoree

Tributary/Reach Gilder Creek

FIRM/Floodway panel # Mauldin City

Date Surveyed 2-6-85

Structure # (Refer to map)	100 yr. Flood Elevation in reference to 1st Floor (in feet)	TYPE	CLASS	Stories	Basement?	Size	Furnishing Class	Yard Damage or Bus. Type	Estimated Damage
1 (4)	< -3							moderate	4,000
2 (2)	0	RBV	B	1	no	A	A	major	13,900
3	-1	RBV	B	1	no	A	A	major	2,050
4	+1	RBV	B	1	no	A	A	moderate	12,900
5	0	RBV	B	1	no	A	A	moderate	6,200
6 (4)	< -3							major	7,000
7 (5)	< -3							moderate	8,750
8 (2)	< -3							moderate	2,000
9 (4)	< -3							minor	2,000
10 (4)	+0	RBV	B	2	no	L	A	moderate	21,750
11 (2)	+0	RBV	B	1	no	A	A	moderate	12,400

92,950

Adapted from USDA, SCS Floodwater Damage Estimates, EWP Technical Guide #21, December 1970, p.5

Greenville

County Flood Area Property Inventory

Basin # 108-010

River Enoree

Tributary/Reach Horsepen Creek

FIRM/Floodway panel # Simpsonville

Date Surveyed 1-8-85

Structure # (Refer to map)	100 yr. Flood Elevation in reference to 1st Floor (in feet)	TYPE	CLASS	Stories	Basement?	Size	Furnishing Class	Yard Damage or Bus. Type	Estimated Damage
1	-5	RBV	B	1	yes	A	A	major	5,650
2 (2)	<-3							moderate	2,000
3	0	RFS	B	2	no	A	A	moderate	4,700
4	0	RBV	B	1	no	A	A	moderate	6,200
									18,550

Structure # (Refer to map)	100 yr. Flood Elevation in reference to 1st Floor (in feet)	TYPE	CLASS	Stories	Basement?	Size	Furnishing Class	Yard Damage or Bus. Type	Estimated Damage
1	0	RFS	B	1½	no	A	A	major	5,500
2 (4)	< -3							moderate	4,000
3	+1	MH				L	A	moderate	2,800
4 (2)	0	RBV	B	1	no	A	A	moderate	12,400
5	+2	RBV	B	1	no	A	A	major	22,250
6	+2	RBV	B	1	no	A	A	major	22,250
7	+2	RFS	B	1½	no	A	A	major	17,150
8	0	RFS	B	1½	no	A	A	moderate	4,800
9	-1	RFS	B	1	no	A	A	moderate	1,300
10	+2	RFS	B	1½	no	A	A	moderate	16,400
11(2)	< -3							moderate	2,000
12(2)	0	RBV	B	1	no	A	A	moderate	12,400
13	< -3							moderate	1,000
									\$124,250

Adapted from USDA, SCS Floodwater Damage Estimates, EWP Technical Guide #21, December 1970, p.5

Greenville

County Flood Area Property Inventory

Basin # 108-010

River Enoree

Tributary/Reach Cane Creek & Trib

FIRM/Floodway panel # Greenville Co. #'s 155 & 165

Date Surveyed 1-11-85

100 yr. Flood
Elevation
in reference
to 1st Floor
(in feet)

Structure #
(Refer to map)

TYPE

CLASS

Stories

Basement?

Size

Furnishing
Class

Yard Damage
or Bus. Type

Estimated
Damage

Structure # (Refer to map)	100 yr. Flood Elevation in reference to 1st Floor (in feet)	TYPE	CLASS	Stories	Basement?	Size	Furnishing Class	Yard Damage or Bus. Type	Estimated Damage
Panel # 155									
1	+0	RBV	B	1	no	A	A	minor	5,700
2	+0	RFS	B	1	no	A	A	moderate	6,200
Panel # 165									
1 (4)	+0	RBV	B	1	no	A	A	moderate	24,800
2 (3)	-6	RBV	B	1	yes	A	A	moderate	10,800
3	-1	RBV	B	1	no	A	A	major	2,050
4	+0	RBV	B	2	no	A	A	major	5,450
								total	60,450
Cane Creek trib.									
1	+0	RBV	B	1	no	A	A	moderate	6,200
								total	6,200

Adapted from USDA, SCS Floodwater Damage Estimates, EWP Technical Guide #21, December 1970, p.5 TOTAL 61,250

Basin # 103-010

River Enoree

Tributary/Reach

Brushy Creek

FIRM/Floodway panel # Greenville Co. #165

Date Surveyed 15 Jan 85

Fairfield Lake
to Wade Hampton

Structure # (Refer to map)	100 yr. Flood Elevation in reference to 1st Floor (in feet)	TYPE	CLASS	Stories	Basement?	Size	Furnishing Class	Yard Damage or Bus. Type	Estimate Damage
1 (2)	< -3							major	3,500
2	-4	RBV	B	1	yes	A	A	major	6,550
3	-6	RBV	B	1	yes	A	A	moderate	3,600
4	+2	RBV	B	2	no	A	A	major	14,150
5 (3)	< -3							major	5,250
6	-5	RBV	B	1	yes	A	A	major	5,650
7	-5	RFS	B	1	yes	A	A	major	5,650
8 (6)	-5	RBV	B	1	yes	A	A	major	33,900
9	< -3							major	1,750
10(2)	< -3							major	3,500
11(6)	-5	RBV	B	1	yes	A	A	major	33,900
12(5)	-6	RBV	B	1	yes	A	A	major	18,000
13(2)	+3	RBV	B	2	no	A	A	major	18,150
14	+3	RBV	B	2	no	A	A	major	18,150
15	+1	RBV	B	1	no	A	A	moderate	13,650
16	-6	RBV	B	1	yes	L	A	moderate	4,100
17 (2)	< -3							minor	500
								total	189,950

Basin # 108-010

River Enoree

Tributary/Reach Rocky Creek

FIRM/Floodway panel # Greenville Co. #165

Date Surveyed 15 Jan 85

Structure # (Refer to map)	100 yr. Flood Elevation in reference to 1st Floor (in feet)	TYPE	CLASS	Stories	Basement?	Size	Furnishing Class	Yard Damage or Bus. Type	Estimated Damage
1	0	RFS	A	1½	no	L	H	major	8,850
2	∇ -3	na						major	1,750
3	0	RBV	A	1	-	L	H	major	9,850
4	-4	COM	na	1	yes	L	na	restaurant	25,000
									45,450

Adapted from USDA, SCS Floodwater Damage Estimates, EWP Technical Guide #21, December 1970, p.5

Basin # 1C8-010

River Enoree

Tributary/Reach Bushy Creek

FIRM/Floodway panel # Greenville Co. #165

Hudson Rd. to Terramont

Detail Map #165-A

Date Surveyed 15 Jan 85

Structure # (Refer to map)	100 yr. Flood Elevation in reference to 1st Floor (in feet)	TYPE	CLASS	Stories	Basement?	Size	Furnishing Class	Yard Damage or Bus. Type	Estimate Damage
1 (2)	+ 0	REV	B	1	no	A	A	major	13,900
2 (6)	< -3							moderate	6,000
3 (2)	+ 0	RBV	B	1	no	A	A	moderate	12,400
4 (7)	+1	RBV	B	1	no	a	a	major	95,550
5 (3)	+ 0	RFS	B	1	no	a	a	moderate	18,600
6 (5)	+ 0	RBV	B	1	no	A	A	moderate	31,000
7 (2)	< -3							moderate	2,000
8 (9)	+ 0	RBV	B	1	no	A	A	major	62,550
9	< -3							minor	500
10	+1	RBV	B	1	no	A	A	major	13,650
11	+ 0	RBV	B	1	no	A	A	moderate	6,200
12	< -3			1				moderate	1,000
13	-3	RBV	B	1	yes	A	A	major	7,350
14	-1	RBV	B	1	yes	A	A	major	8,550
15	+ 0	RBV	B	1	no	L	A	major	8,000
									287,250

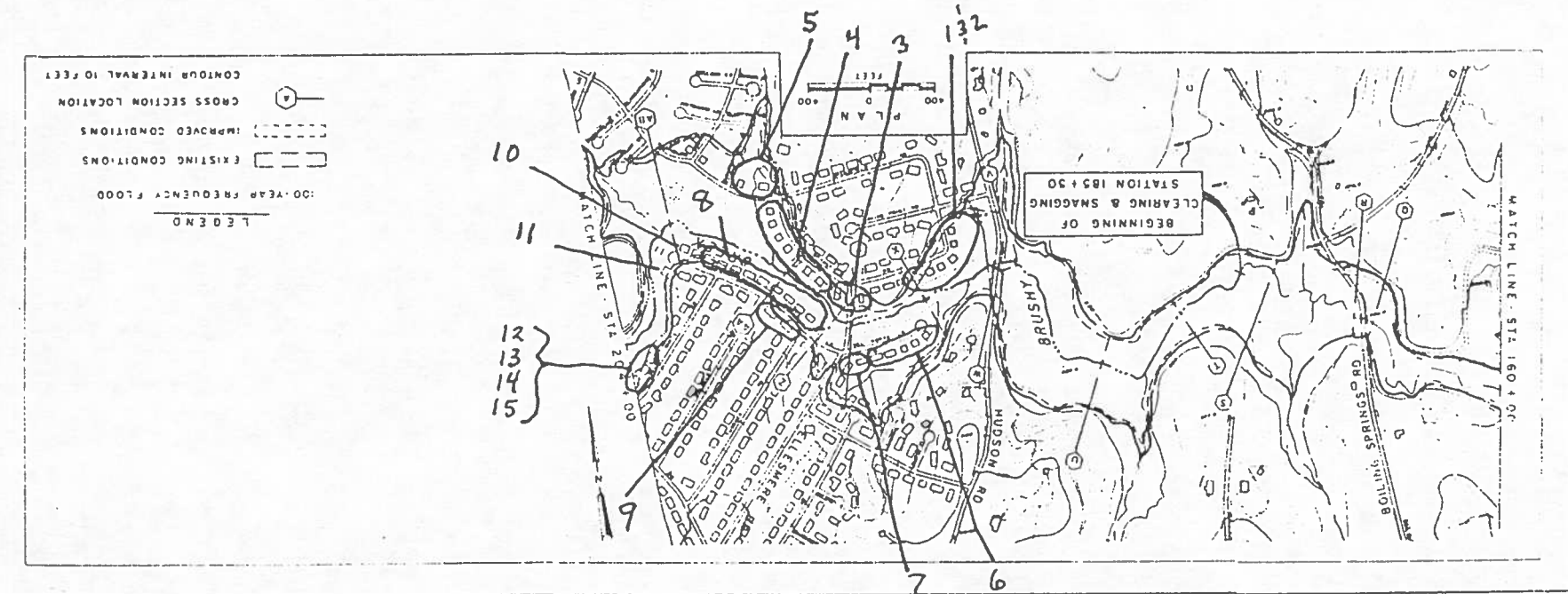
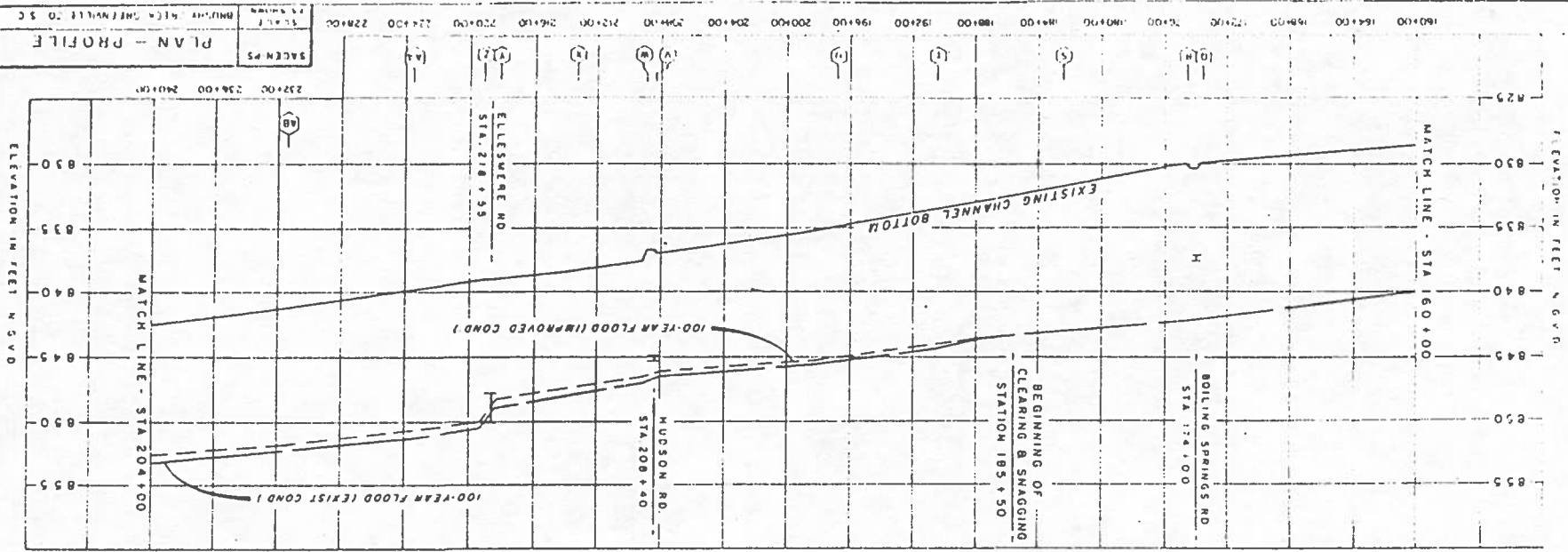

DETAIL MAP # 165A Brushy Creek: Hudson to Terramount

Basin # 108-010

River Enoree

Tributary/Reach Brushy Creek

FIRM/Floodway panel # Greenville Co. #165

Date Surveyed 16 Jan 85

Detail Map #165B

Structure # (Refer to map)	100 yr. Flood Elevation in reference to 1st Floor (in feet)	TYPE	CLASS	Stories	Basement?	Size	Furnishing Class	Yard Damage or Bus. Type	Estimated Damage
1	-2	RBV	B	1	yes	A	A	major	7,950
2	+0	RFS	B	2	no	L	A	major	6,200
3 (2)	+1	RBV	B	1	no	A	A	major	27,300
4	< -3							moderate	1,000
5	+1	RBV	B	1	no	L	A	moderate	15,300
6	+0	RFS	B	1½	no	A	A	major	5,550
7	+0	RFS	B	1	no	A	A	moderate	6,200
8 (3)	< -3							moderate	3,000
9 (4)	+0	RBV	B	1	no	A	A	moderate	24,800
10	< -3							moderate	1,000
11(9)	< -3								9,000
12	+0	RBV	B	1	no	L	A	major	8,000
13	+0	RBV	B	2	no	L	A	major	6,300
14(2)	-6	RBV	B	1	yes	L	A	moderate	8,200
15	-6	RBV	B	2	yes	L	A	moderate	4,000
16	+3	RFS	B	2	no	L	A	major	21,500
									155,300

Adapted from USDA, SCS Floodwater Damage Estimates, EWP Technical Guide #21, December 1970, p.5

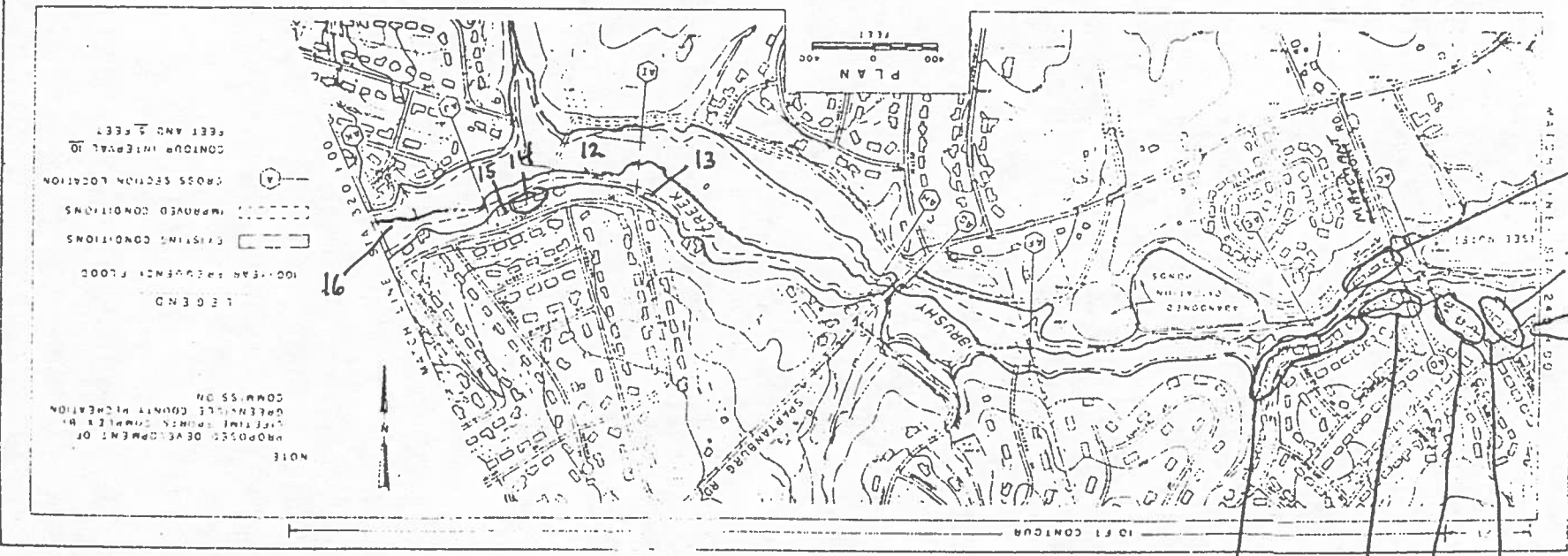
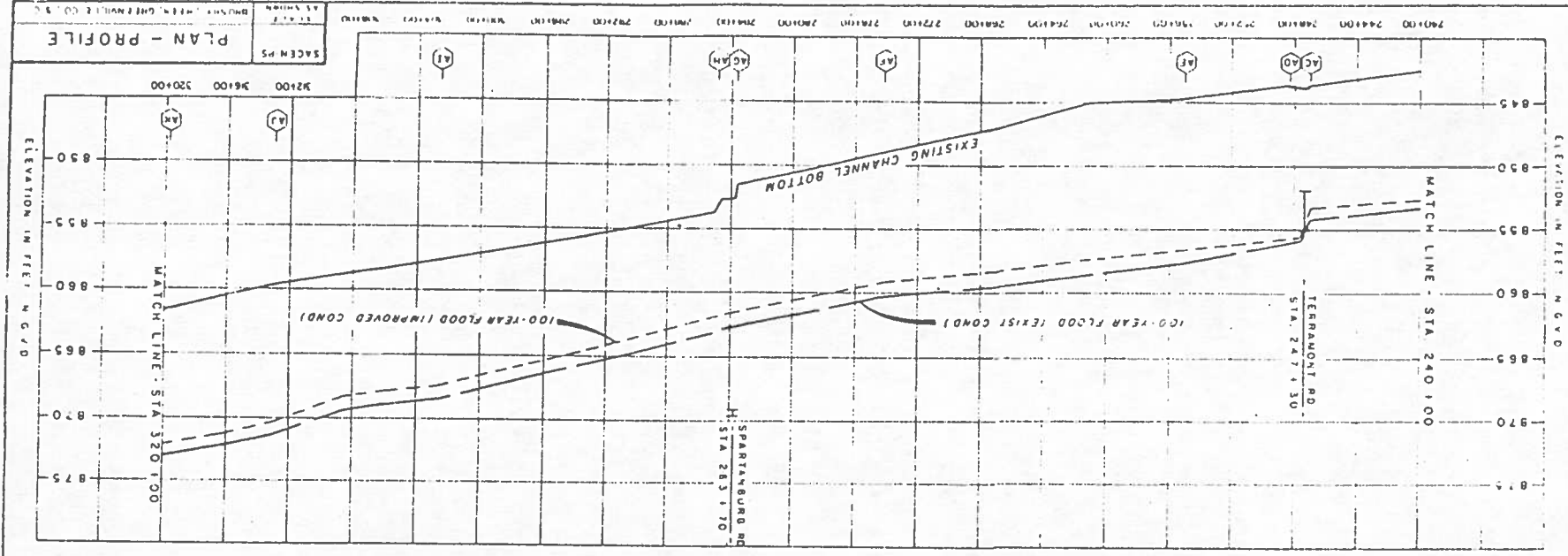

Detail Map # 165 B Brushy Creek: Marchant to Kenilworth

- 1
- 2
- 3
- 4
- 6, 7, 8
- 9
- 10
- 11
- 12
- 13
- 14
- 15
- 16

Basin # 108-010 River Enoree

Tributary/Reach Brushy Creek

FIRM/Floodway panel # Greenville Co. #165

Kenilworth to Shannon

Date Surveyed 15 Jan 85

Detail map #165 C

Structure # (Refer to map)	100 yr. Flood Elevation in reference to 1st Floor (in feet)	TYPE	CLASS	Stories	Basement?	Size	Furnishing Class	Yard Damage or Bus. Type	Estimate Damage
1	<-3							moderate	1,000
2	0	RBV	B	2	no	L	A	moderate	15,400
3 (7)	0	RBV	B	1	no	A	A	moderate	44,400
4 (2)	0	RBV	B	1	no	A	A	moderate	12,400
5	+2	RBV	B	1	no	A	A	moderate	21,500
6	+3	RBV	B	2	no	A	A	moderate	17,400
7 (2)	0	RBV	B	1	no	A	A	moderate	12,400
8	0	RBV	B	2	no	A	A	moderate	4,700
9	+3	RBV	B	2	no	A	A	major	18,150
10(3)	0	RBV	B	1	no	A	A	major	20,850
11(4)	0	RBV	B	1	no	A	A	moderate	24,800
12(4)	<-3							moderate	1,000
13	0	RBV	B	1	no	A	A	moderate	6,200
14	<-3							major	2,000
15	+3	DUPLEX	B	1	no	A	A	minor	28,600
16	+2	DUPLEX	B	1	no	A	A	minor	21,000
17	<-3							major	1,750
18	+2	RBV	B	2	no	A	A	major	14,150
									267,700

Adapted from USDA, SCS Floodwater Damage Estimates, EWP Technical Guide #21, December 1970, p.5

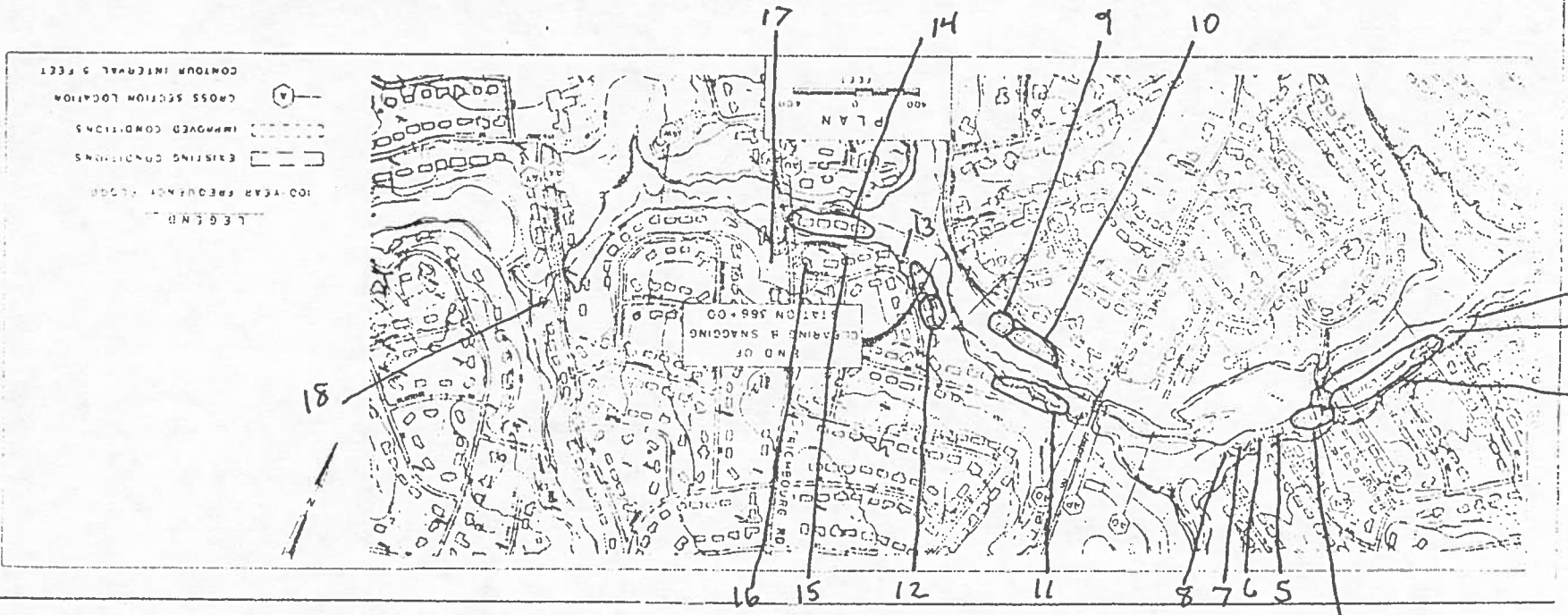
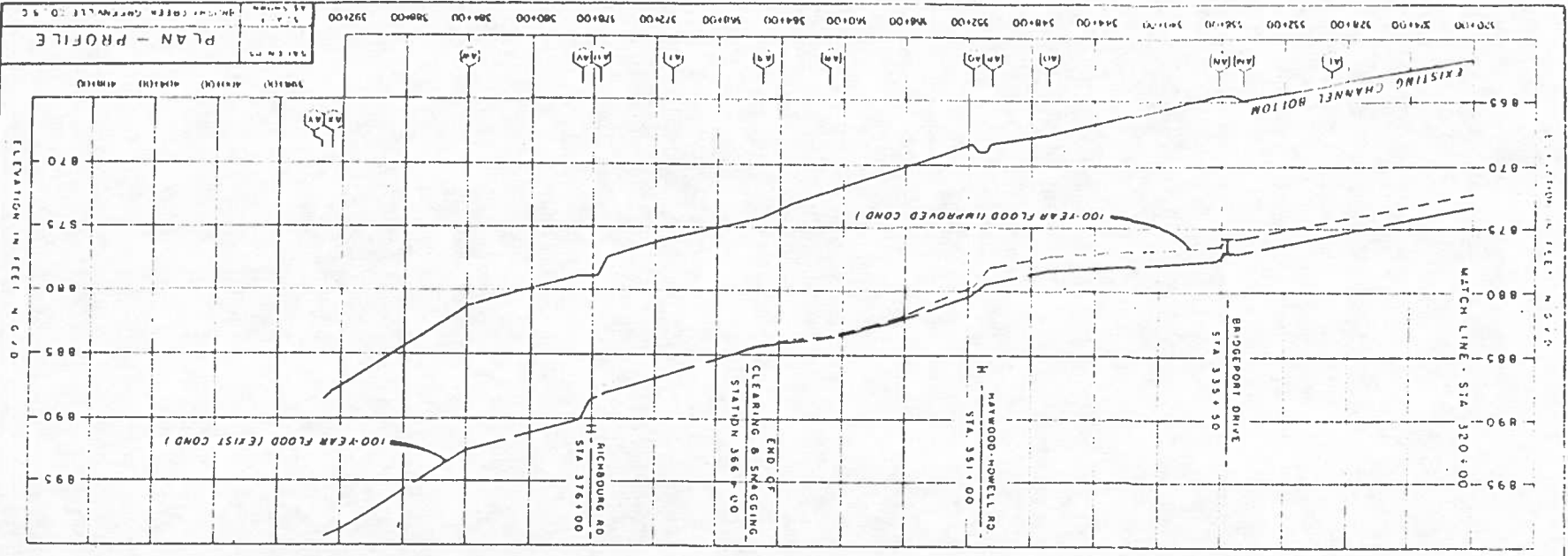

Detail Map # 165C Brushy Creek; Kenilworth to Shannon

Greenville

County Flood Area Property Inventory

Basin # 108-010

River Enoree

Tributary/Reach Suber Rd to County line

FIRM/Floodway panel # Greenville 170

Date Surveyed 12-11-84

Structure # (Refer to map)	100 yr. Flood Elevation in reference to 1st Floor (in feet)	TYPE	CLASS	Stories	Basement?	Size	Furnishing Class	Yard Damage or Bus. Type	Estimated Damage
1	+2	MH	-	-	-	L	A	minor	3,200

Basin # 109-010

River North Saluda

Tributary/Reach Callahan RD.

FIRM/Floodway panel # Greenville Co #25 & #100

Date Surveyed 16 Jan 84

100 yr. Flood
Elevation
in reference
to 1st Floor
(in feet)

Structure

(Refer to
map)

TYPE

CLASS

Stories

Basement?

Size

Furnishing
Class

Yard Damage
or Bus. Type

Estimate
Damage

Panel #25

1 (4)	+0	RFS	C	1	no	A	A	major	18,600
-------	----	-----	---	---	----	---	---	-------	--------

Panel #100

1 (3)	+0	RFS	C	1	no	S	A	major	12,100
-------	----	-----	---	---	----	---	---	-------	--------

2	+2	COM (NURSERY BUILDING)							10,000
---	----	------------------------	--	--	--	--	--	--	--------

3	+1	RFS	C	1	no	S	A	minor	4,100
---	----	-----	---	---	----	---	---	-------	-------

4	+2	RFS	C	1	no	S	L	minor	4,800
---	----	-----	---	---	----	---	---	-------	-------

								TOTAL	49,600
--	--	--	--	--	--	--	--	-------	--------

Basin # 109 010 River Saluda

Tributary/Reach Armstrong Creek

FIRM/Floodway panel # Greenville Co. #130

Date Surveyed 11 Jan 85

Structure # (Refer to map)	100 yr. Flood Elevation in reference to 1st Floor (in feet)	TYPE	CLASS	Stories	Basement?	Size	Furnishing Class	Yard Damage or Bus. Type	Estimated Damage
1	-4	RBV	B	1	yes	A	A	major	6,550
2	<-3							major	1,750
3	+3	MH	-	-	-	M	A	minor	2,900
									11,200

Adapted from USDA, SCS Floodwater Damage Estimates, EWP Technical Guide #21, December 1970, p.5

Basin # 109-010

River Saluda

Tributary/Reach Piedmont to Grove Creek

FIRM/Floodway panel # Greenville Co. #250

Date Surveyed 18 Dec. 84 ^{Confluence}

Structure # (Refer to map)	100 yr. Flood Elevation in reference to 1st Floor (in feet)	TYPE	CLASS	Stories	Basement?	Size	Furnishing Class	Yard Damage or Bus. Type	Estimate Damage
1	+1	MH	-	-	-	L	A	minor	1,400
2	+0	RFS	C	1	no	S	A	moderate	3,290
3	-2	RFS	C	1	yes	S	A	moderate	1,200
									5,890

Adapted from USDA, SCS Floodwater Damage Estimates, EWP Technical Guide #21, December 1970, p.5

Basin # 109-020

River Middle Saluda

Tributary/Reach Jones Gap/Gap Creek

FIRM/Floodway panel # Greenville Co. 25

Date Surveyed 16 Jan 84

Structure # (Refer to map)	100 yr. Flood Elevation in reference to 1st Floor (in feet)	TYPE	CLASS	Stories	Basement?	Size	Furnishing Class	Yard Damage or Bus. Type	Estimated Damage
1 (2)	+1	RFS	B	1	no	S	A	minor	9,000
2	+1	RFS	B	1	no	S	A	moderate	5,000
3	+2	GATEHOUSE & TACK ROOM			GIRL SCOUT CAMP				5,000
4	+2	RFS	C	1	no	A	A	minor	8,000
5	+3	RFS	B	1	no	A	A	major	30,000
6	+0	RFS	B	1	no	A	A	minor	5,700
7	+2	RFS	B	2	no	L	A	major	25,000
8	+2	MH	-	-	-	L	A	major	4,500

92,200

Basin # 109-020

River South Saluda

Tributary/Reach Table Rock to CR125

FIRM/Floodway panel # Greenville Co. #75 & #100

Date Surveyed 16 Jan 85

100 yr. Flood
Elevation
in reference
to 1st Floor
(in feet)

Structure

(Refer to
map)

Structure # (Refer to map)	100 yr. Flood Elevation in reference to 1st Floor (in feet)	TYPE	CLASS	Stories	Basement?	Size	Furnishing Class	Yard Damage or Bus. Type	Estimate Damage
panel 75									
1	+1	RFS	C	1	no	A	A	moderate	5,600
2	+1	RBV	B	1	no	A	A	moderate	12,900
3	+4	RFS	C	1	no	S	A	minor	12,800
4	+4	RFS	C	2	no	A	A	minor	10,400
5								major	1,750
								total	43,450
anel 100									
1	+1	COM (Gen. Store		1	no	30x40	NA		20,000
2	+2	RFS	B	1	no	S	A	minor	16,250
3	+1	RBV	B	1	no	L	A	minor	25,100
								Total	61,350
									104,800

Adapted from USDA, SCS Floodwater Damage Estimates, EWP Technical Guide #21, December 1970, p.5

Basin # 109-020

River Middle Saluda

Tributary/Reach Gap Creek to confluence

FIRM/Floodway panel # Greenville Co. #100

Date Surveyed 16 Jan 85

Structure # (Refer to map)	100 yr. Flood Elevation in reference to 1st Floor (in feet)	TYPE	CLASS	Stories	Basement?	Size	Furnishing Class	Yard Damage or Bus. Type	Estimate Damage
1	+1	RFS	B	1	no	A	A	MAJOR	13,700
2 (3)	+0	RFS	C	1	no	S	A	MINOR	7,400
3	+1	MH				L	A	MINOR	2,000
4	+2	COM(River Falls Lodge)					100x40		20,000
5 (3)	+1	MH				L	A	MAJOR	3,500
6	+1	RFS	B	1	no	S	A	MINOR	9,700
7	0	COM (Gen. Store)					20x30		5,000
8	+1	RFS	B	1½	no	A	A	MAJOR	10,500
9	+1	COM (Gen. Store)					20x50		10,000
10	+4	RFS	C	1	no	A	A	MODERATE	13,300
11	+2	COM (Gen. Store)				no	A	A	20,000
12 (2)	+1	RFS	C	1	no	A	A	MINOR	<u>10,200</u>
									125,300

Adapted from USDA, SCS Floodwater Damage Estimates, EWP Technical Guide #21, December 1970, p.5

Basin # 109-100 River Reedy Tributary/Reach Langston Creek Confluence
 FIRM/Floodway panel # 145 Greenville Co. Date Surveyed 1-28-85

Structure # (Refer to map)	100 yr. Flood Elevation in reference to 1st Floor (in feet)	TYPE	CLASS	Stories	Basement?	Size	Furnishing Class	Yard Damage or Bus. Type	Estimated Damage
1	+0	COM	n/a	1	no	30 50	n/a	Auto parts	30,000
2	+1	IND	n/a	3	n/a	American	finishing		n/a
									30,000

Adapted from USDA, SCS Floodwater Damage Estimates, EWP Technical Guide #21, December 1970, p.5

Easin # 109-100

River Reedy

Tributary/Reach Langston Creek Trib

FIRM/Floodway panel # Greenville Co. #145

Date Surveyed 1-16-85

detail map (145 A)

Structure # (Refer to map)	100 yr. Flood Elevation in reference to 1st Floor (in feet)	TYPE	CLASS	Stories	Basement?	Size	Furnishing Class	Yard Damage or Bus. Type	E
1(4)	-1	RFS	B	1	no	A	A	moderate	5
2	+1	RBV	B	2	no	A	A	moderate	8
3	0	RBV	B	1	no	duplex	A	moderate	6
4	+2	RFS	B	1	no	S	A	minor	1
5(12)	+1	MH	n/a	1	n/a	L	A	minor	2
6(5)	+1	RFS	C	1	no	S	A	minor	2
7(10)	+1	MH	n/a	1	n/a	L	A	minor	2
8(7)	+3	RFS	C	1	no	S	A	moderate	5
9(9)	+1	RFS	C	1	no	S	A	moderate	3
10	+3	RFS	C	1	no	S	A	moderate	8
11	+1	RBV	C	1	no	S	A	major	5
12(2)	+1	RBV	B	1	no	duplex	A	moderate	2
13(3)	+1	RFS	C	1	no	S	A	moderate	1
14(8)	<-3							moderate	8
15(14)	+0	RFS	B	1	no	S	A	moderate	7

DETAIL MAP # 145A LANGSTON CREEK



Basin # 109-100

River Reedy

Tributary/Reach Little Creek

FIRM/Floodway panel # Greenville Co. # 145

Date Surveyed 16 Jan 85

Detail Map #145 B

Structure # (Refer to map)	100 yr. Flood Elevation in reference to 1st Floor (in feet)	TYPE	CLASS	Stories	Basement?	Size	Furnishing Class	Yard Damage or Bus. Type	Estimated Damage
1 (2)	-1	RBV	B	1	no	A	A	major	4,000
2	+1	RBV	B	1	no	A	A	major	13,650
3 (2)	0	RBV	C	1	no	A	A	major	9,500
4	0	RBV	C	1	no	DUPLEX	A	minor	2,400
5	0	RBV	B	2	no	A	A	moderate	4,700
6	0	RBV	B	2	no	A	A	major	5,450
7 (6)	0	RBV	B	1	no	A	A	major	48,650
8 (2)	∇ -3	na						major	3,500
9	0	RBV	B	2	no	A	A	major	5,450
								TOTAL	97,300

Adapted from USDA, SCS Floodwater Damage Estimates, EWP Technical Guide #21, December 1970, p.5

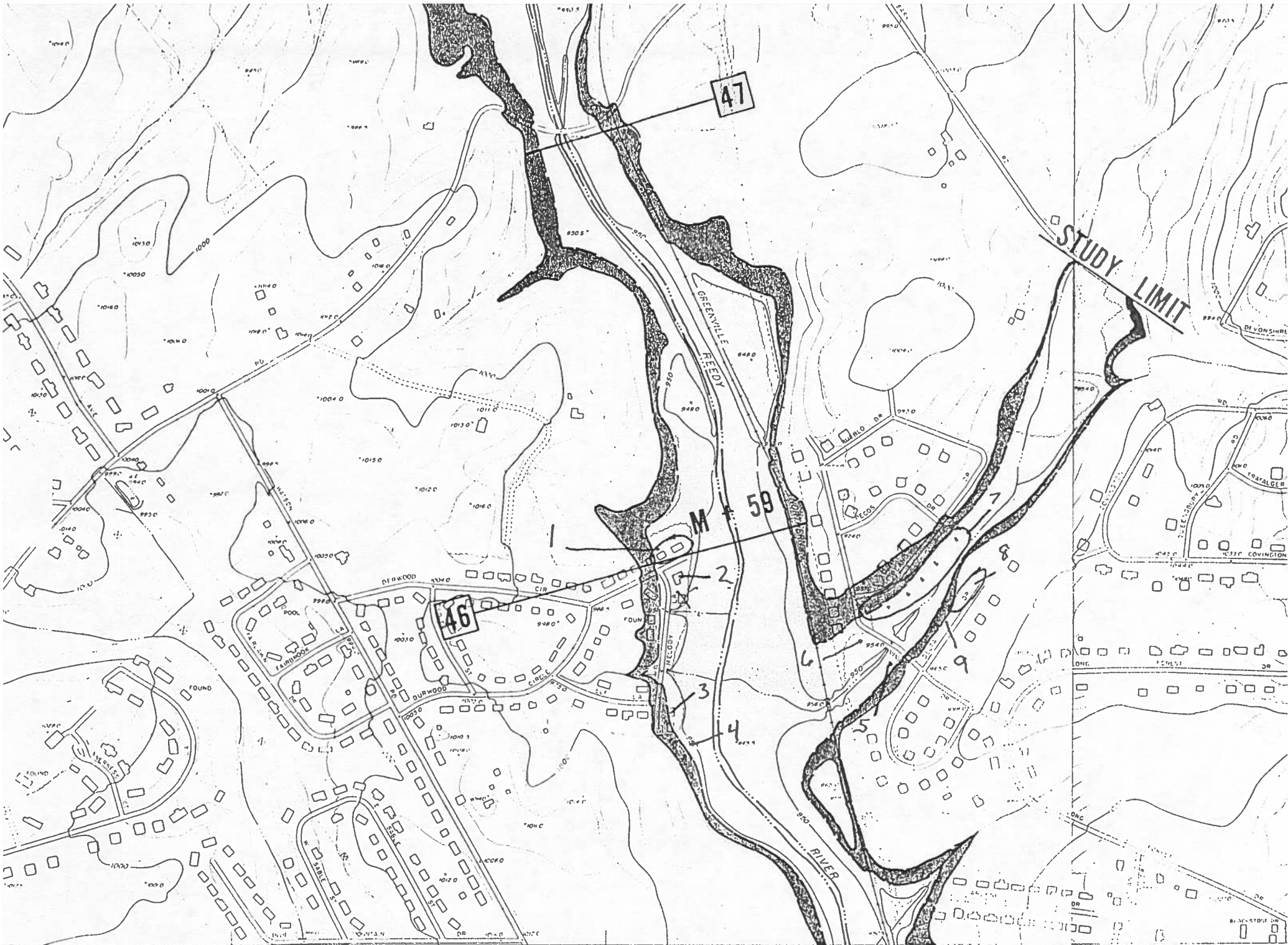

MATCH LINE PLATE 19

Basin # 109-100

River Reedy

Tributary/Reach Jones Cir. to Sulphur Springs rd.

FEM/Floodway panel # Greenville Co. #145

Date Surveyed 16 Jan. 85

Detail map #145C

Structure # (Refer to map)	100 yr. Flood Elevation in reference to 1st Floor (in feet)	TYPE	CLASS	Stories	Basement?	Size	Furnishing Class	Yard Damage or Bus. Type	Estimate Damage
1	to	MH	n/a	1	no		A	MAJOR	3,600
2	↙-3							MAJOR	1,750
3(2)	↙-3							MODERATE	2,000
4	↙-3							MODERATE	1,000
								TOTAL	8,350



MATCH LINE PLATE 18

DETROIT MAP # 145 C Jones Cir. To Suburban Spruce

Basin # 109-100

River Reedy

Tributary/Reach Long Branch

FIRM/Floodway panel # Greenville Co. #145

Date Surveyed 18 DEC 84

Structure # (Refer to map)	100 yr. Flood Elevation in reference to 1st Floor (in feet)	TYPE	CLASS	Stories	Basement?	Size	Furnishing Class	Yard Damage or Bus. Type	Est D
1	+0	COM	C	1	no	30x60	na	Body shop	10,000
2	+1	COM	C	1	no	20x40	na	Tavern	3,000
3 (2)	0	RFS	C	1	no	S	A	minor	5,600
4	0	MH	na	1	no	M	A	minor	1,100
5 (8)	0	RFS	C	1	no	S	A	minor	22,300
6 (3)	-1	RFS	C	1	no	A	A	minor	2,100
7	-1	RFS	C	1	no	A	A	major	2,000
								total	46,100

Adapted from USDA, SCS Floodwater Damage Estimates, EWP Technical Guide #21, December 1970, p.5

Greenville

County Flood Area Property Inventory

Basin # 10 9-100

River Reedy

Tributary/Reach Brushy Creek

FIRM/Floodway panel # Greenville Co. #185

Date Surveyed 12-19-85

Structure # (Refer to map)	100 yr. Flood Elevation in reference to 1st Floor (in feet)	TYPE	CLASS	Stories	Basement?	Size	Furnishing Class	Yard Damage or Bus. Type	Estimated Damage
1	+2	MH				L	A	minor	3,200
2	+0	RFS	B	1	no	A	A	major	6,950
3	+1	MH				L	A	minor	2,300
4 (2)	+0	RFS	B	1	no	S	A	minor	9,200
5 (2)	< -3	n/a						major	3,500
6 (3)	+0	RFS	B	1	no	S	A	major	17,550
7	+1	MH				L	A	minor	2,300
8 (4)	+0	RFS	B	1	no	S	A	moderate	20,400
9 (4)	< -3							moderate	4,000
10 (5)	< -3							minor	2,500
11 (2)	+0	RFS	C	1½	no	A	A	minor	3,400
									75,300

Basin # 109-100

River Reedy

Tributary/Reach Stallings Br

FIRM/Floodway panel # Greenville Co. #215

Date Surveyed 29 Nov 84

Structure # (Refer to map)	100 yr. Flood Elevation in reference to 1st Floor (in feet)	TYPE	CLASS	Stories	Basement?	Size	Furnishing Class	Yard Damage or Bus. Type	Estimate Damage
1	+2	RFS	C	1	no	S	A	major	7,650
									7,650

Adapted from USDA, SCS Floodwater Damage Estimates, EWP Technical Guide #21, December 1970, p.5

Greenville

County Flood Area Property Inventory

Basin # 109-100

River Reedy

Tributary/Reach Richland #5

FIP/Floodway panel # Greenville City #2

Date Surveyed 1-9-84

Structure # (Refer to map)	100 yr. Flood Elevation in reference to 1st Floor (in feet)	TYPE	CLASS	Stories	Basement?	Size	Furnishing Class	Yard Damage or Bus. Type	Estimated Damage
1	+2	RFS	B	2	no	A	A	major	21,150
2	+0	RBV	B	2	no	A	A	major	11,650
3	+2	RBV	A	1	no	L	H	major	45,400
4	< -3							major	1,750
5	< -3							minor	500
6 (2)	+4	RFS	B	1	no	A	A	major	66,900
7	+4	RBV	B	1	no	A	A	major	33,450
8 (5)	-4	RBV	B	1	yes	A	A	major	32,750
9	+0	RFS	A	3	no	L	H	major	9,000
10	< -3							minor	500
11(5)	< -3							minor	2,500
12	+0	RBV	B	1	no	A	A	moderate	6,200
13	+0	RFS	B	1	no	A	A	moderate	6,200
									237,950

Basin # 109-100

River Reedy

Tributary/Reach Willard Street to

FIRM/Floodway panel # Greenville City #4

Date Surveyed 1-19-3-12-85 Academy Street

Detail Map #4a

Structure # (Refer to map)	100 yr. Flood Elevation in reference to 1st Floor (in feet)	TYPE	CLASS	Stories	Basement?	Size	Furnishing Class	Yard Damage or Bus. Type	Estimate Damage
1 (3)	<-3								3,000
2 (2)	+1	RFS	C	1	no	duplex	A	MINOR	10,200
3 (2)	+0	RFS	C	1	no	duplex	A	MINOR	6,800
4 (3)	+0	RBV	C	1	no	duplex	A	MINOR	10,200
5	+2	COM	C	1	no	20x30	NA	GROCERY	50,000
6	+2	COM	C	1	no	20x30	NA	BEAUTY PARLOR	20,000
7	+1	COM	C	1	no	30x30	NA	TAVERN	25,000
8	+2	COM	C	1	no	12x20	NA	GAS/BEER	30,000
9 (11)	+1	RBV	C	1	no	S	L	RENTAL UNITS	22,000
10	+0	RFS	C	1	no	S	A	MAJOR	4,000
11 (5)	-1	RFS	C	1	no	S	A	MAJOR	10,000
12	+0	RFS	C	1	no	S	A	MAJOR	4,000
13	+1	COM	NA	1	no	30x100	NA	WAREHOUSE	10,000
14	+1	COM	NA	1	no	50x100	NA	WHOLESALE	2,000,00
15	+1	COM	NA	1	no	50x50	NA	WHOLESALE	100,000
16	+1	COM	NA	1	no	100x100	NA	VACANT	20,000
17	+1	PUBLIC	NA	1	no	40x100	NA	CITY ENG.	
18	+1	PUBLIC	NA	1	no	20x100	NA	CITY ENG.	10,000
19	+3	COM	NA	2	no	50x100	NA	MATTRESS FAC.	50,000
20	+1	COM	NA	2	no	100x400	NA	TEXTILE	250,000
21	+1	COM	NA	1	no	100x600	NA	WAREHOUSE	400,000
22	+1	COM	NA	1	no	50x200	NA	WAREHOUSE	40,000
23	+1	COM	NA	1	no	50x200	NA	WASTE PAPER	20,000
24	+1	COM	NA	1	no	50x100	NA	BEER DIST.	250,000
25	+1	COM	NA	1	no	50x100	NA	WAREHOUSE	1,000
26	<-3								
27	city maintenance park							n/a	
								TOTAL	3,344,200

Detail MAP; City of Greenville panel # 4A, Willard st. to Academy ST

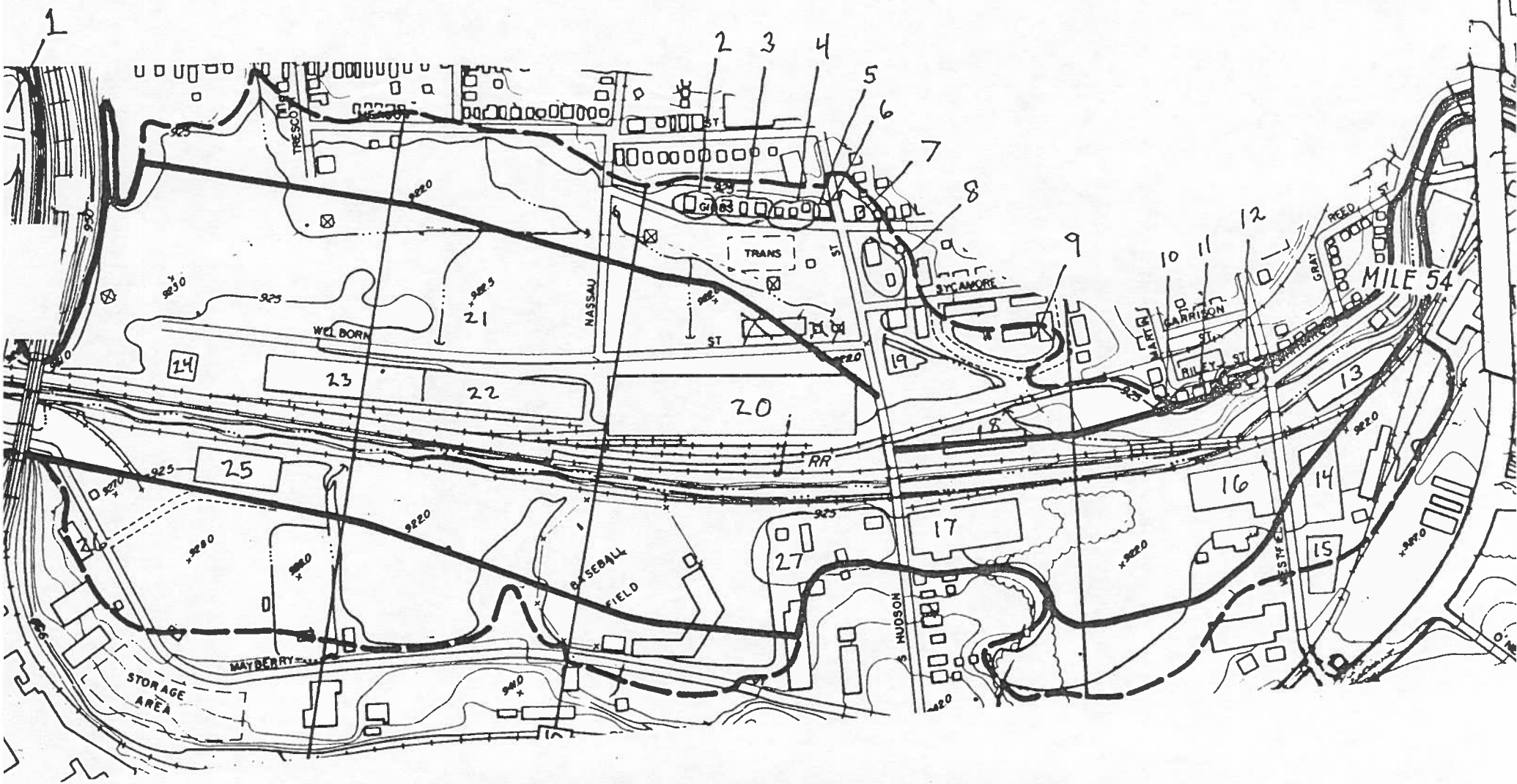

Basin # 109-100

River Reedy

Tributary/Reach Academy St. to Main St.

FIRM/Floodway panel # City of Greenville #5 &
Detail map # 5A

Date Surveyed 3-12-85



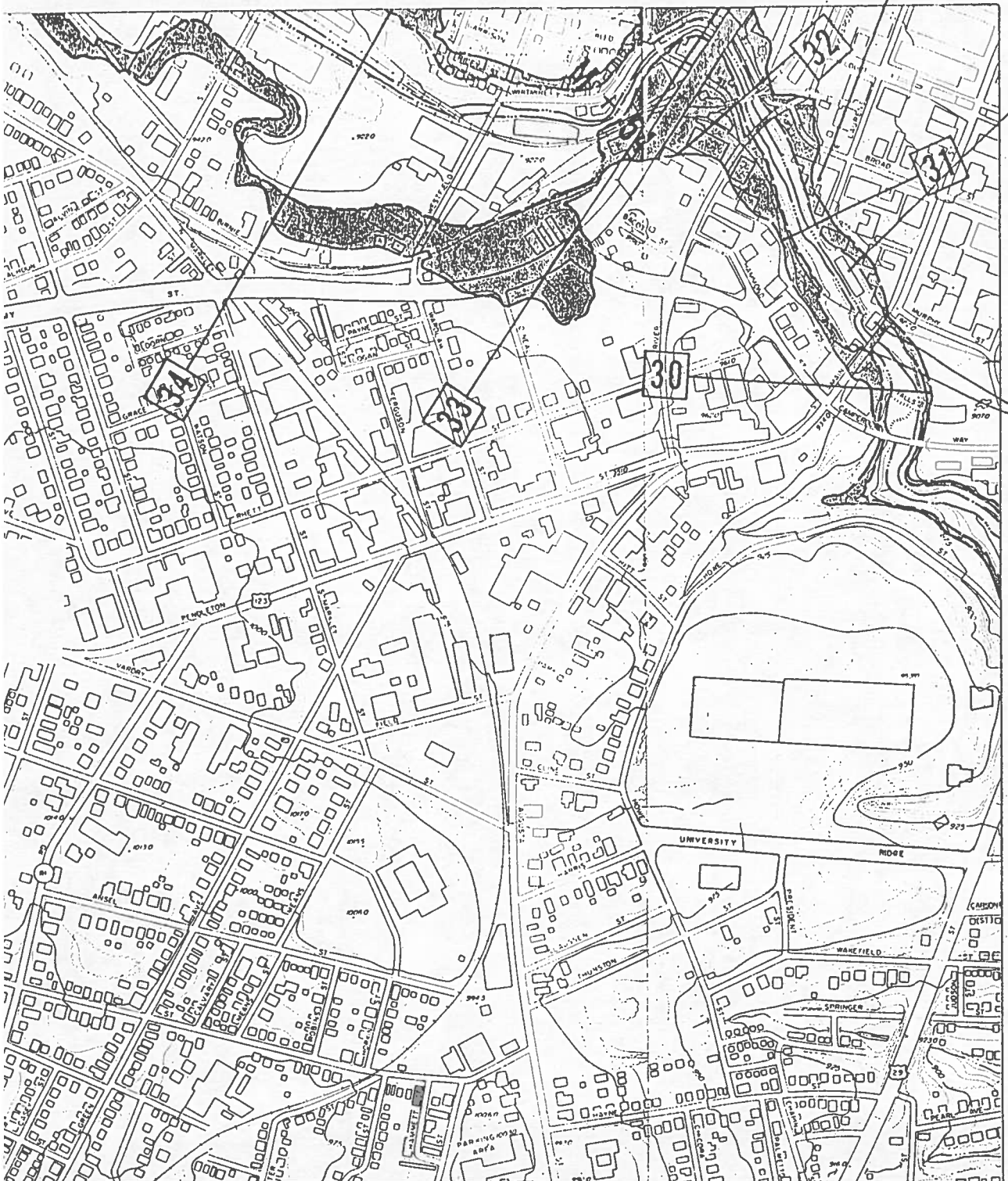

Structure # (Refer to map)	100 yr. Flood Elevation in reference to 1st Floor (in feet)	TYPE	CLASS	Stories	Basement?	Size	Furnishing Class	Yard Damage or Bus. Type	Estimated Damage
1	+1	COM	n/a	3	n/a	40x200	n/a	outlet warehouse	100,000

Adapted from USDA, SCS Floodwater Damage Estimates, EWP Technical Guide #21, December 1970, p.5



Abandoned

LEGEND

- OVERFLOW LIMITS
-  INTERMEDIATE REGIONAL FLOOD
 -  STANDARD PROJECT FLOOD
 - M + 4 MILES ABOVE MOUTH
 -  CROSS SECTION
 -  900 GROUND ELEVATION IN FEET ABOVE MEAN SEA LEVEL
 -  CITY LIMITS
 -  CHANNEL
- built above flood level

NOTES

1. BASE MAP FURNISHED BY GREENVILLE COUNTY PLANNING COMMISSION, GREENVILLE, S. C.
2. LIMITS OF OVERFLOW SHOWN MAY VARY FROM ACTUAL LOCATION ON GROUND AS EXPLAINED IN THE REPORT.
3. AREAS OUTSIDE THE FLOOD PLAIN MAY BE SUBJECT TO FLOODING FROM LOCAL RUNOFF.
4. CONTOUR INTERVAL IS 5 FEET.

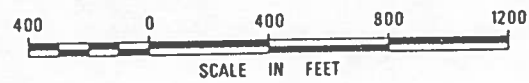

Detail Map 5A Reedy River: Academy St to Main St.

Greenville

County Flood Area Property Inventory

Basin # 109-100

River Reedy

Tributary/Reach Richland Cr. to Reedy R.

FIRM/Floodway panel # City of Greenville #5

Date Surveyed 1-28-85

Structure # (Refer to map)	100 yr. Flood Elevation in reference to 1st Floor (in feet)	TYPE	CLASS	Stories	Basement?	Size	Furnishing Class	Yard Damage or Bus. Type	Estimated Damage
1	-6	RBV	B	1	yes	A	A	minor	3,100
2	0	COM	n/a	1	no	20X50		--	5,000
3	-6	COM	n/a	1	yes	Abandoned			n/a
4	+1	PUB	n/a	2	no	park	maintenance		n/a
5	+1	PUB	n/a	1	no	Recreation center			n/a
6	-6	RBV	B	1	yes	A	A	moderate	3,600
7	-3	COM	n/a	1	no	Barn		major	1,750
									13,450

Basin # 109-100 River Reddy Tributary/Reach US 29 & Scarlett St.

FIRM/Floodway panel # Greenville City #8 Date Surveyed 3-12-85

Structure # (Refer to map)	100 yr. Flood Elevation in reference to 1st Floor (in feet)	TYPE	CLASS	Stories	Basement?	Size	Furnishing Class	Yard Damage or Bus. Type	Estimated Damage
1	+3	RBV	B	1	no	A	A	abandoned	
2	0	RFS	B	1	no	A	A	minor	5,600.
3	1	RBV	B	1	no	A	A	major.	13,650
4	0	RFS	B	1	no	A	A	major	6,950
5 (2)	<-3							major	3,500
6	<-3							major	1,750
									31,450

Adapted from USDA, SCS Floodwater Damage Estimates, EWP Technical Guide #21, December 1970, p.5

Basin # 109-100 River Reedy Tributary/Reach Reedy River Trib. #2

FIRM/Floodway panel # Greenville #8 & #9 Date Surveyed 1-19-84
 City

Structure # (Refer to map)	100 yr. Flood Elevation in reference to 1st Floor (in feet)	TYPE	CLASS	Stories	Basement?	Size	Furnishing Class	Yard Damage or Bus. Type	Estimated Damage
panel #9									
1	+0	RFS	A	1	-	L	H	major	12,250
2(2)	+0	RBV	A	2	-	L	H	major	16,350
								subtotal	28,600
panel #9									
1	0	RFS	A	2	no	L	H	major	9,000
2	-2	RBV	A	2	yes	L	H	moderate	23,900
3	-6	RFS	A	1½	yes	L	H	moderate	14,200
								subtotal	47,200
								TOTAL	75,800

Adapted from USDA, SCS Floodwater Damage Estimates, EWP Technical Guide #21, December 1970, p.5

Greenville

County Flood Area Property Inventory

Basin # 109-100

River Reedy

Tributary/Reach Rock Creek

FIRM/Floodway panel # Simpsonville

Date Surveyed 1-8-85

Structure # (Refer to map)	100 yr. Flood Elevation in reference to 1st Floor (in feet)	TYPE	CLASS	Stories	Basement?	Size	Furnishing Class	Yard Damage or Bus. Type	Estimated Damage
1	-1	RBV	B	1	no	A	A	moderate	1,300
2 (2)	-3							moderate	2,000
3	-6	RBV	B	1	yes	A	A	moderate	3,600
4 (4)	-4	RFS	B	1	yes	A	A	moderate	23,200
5 (5)	-3							moderate	5,000
6	-4	RBV	B	2	yes	A	A	major	6,850
7	-5	RBV	B	2	yes	A	A	moderate	5,100
8 (4)	+0	MH				L	A	minor	5,600
9 (2)	+0	MH				L	A	minor	2,800
10	+3	MH				DW	A	moderate	8,100
11	+2	MH				L	A	moderate	3,700
									67,250