

CITY OF COLUMBIA, S.C.
DEPARTMENT OF UTILITIES AND ENGINEERING

THIS MAP OR PLAN IS THE PRODUCT OF
COMPILATION, OR WAS PRODUCED BY OTHERS.
IT IS PROVIDED FOR INFORMATION ONLY AND THE
CITY OF COLUMBIA MAKES NO REPRESENTATIONS
AS TO ITS ACCURACY. ITS USE WITHOUT FIELD
VERIFICATION IS AT THE SOLE RISK OF THE USER.

GRAPHIC SCALE IN FEET
SCALE: 1" = 30'

NOTES:

- GENERAL UTILITY CROSSINGS MAY EXIST THAT ARE NOT SHOWN ON THIS PROFILE.
- AS SHOWN, PIPE LENGTHS ARE CENTER TO CENTER OF STRUCTURES.

COX AND DINKINS
ENGINEERS ARCHITECTS AND LANDSCAPE ARCHITECTS
724 BELT LINE BLVD.
COLUMBIA, SC 29208
803.734.0300
COXANDINKINS.COM

WILLIAM E. COLEMAN
REGISTERED PROFESSIONAL ENGINEER
NO. 14890

COX AND DINKINS, INC.
NO. 00094
REGISTERED PROFESSIONAL ENGINEER
STATE OF SOUTH CAROLINA

REVISIONS	DESCRIPTION

DATE: _____

PROJECT PERMITTEE:
COLUMBIA HOUSING
CINDY HERRERA
SVP OF DEVELOPMENT
1917 HARDEN STREET
COLUMBIA, SC 29204

843-810-5073

68161
cdinkins@coxanddinkins.com

THE OAKS AT ST. ANNA'S PARK

LOCATED IN THE CITY OF COLUMBIA
RICHLAND COUNTY, SOUTH CAROLINA

PROJECT NO. 30017
DATE 7/9/2021

SANITARY SEWER PROFILES

100 TO BE ASSIGNED

48C-02C

DATE 7/9/2021

SHEET **C28** OF **55**

SCHEDULE OF BUILDINGS					
BLDG. NUMBER	4 RM FLATS	4 1/2 RM FLATS	5 1/2 RM FLATS	NO. UNITS	ROOMS
25 AND 26	4	16	16	36	122
27, 28, 29, 30	16	16	16	64	228
TOTALS	20	32	32	100	350
ROOMS TOTAL	16	72	88	82	228
AVERAGE NUMBER OF ROOMS PER DWELLING UNIT				2.16 ROOMS	

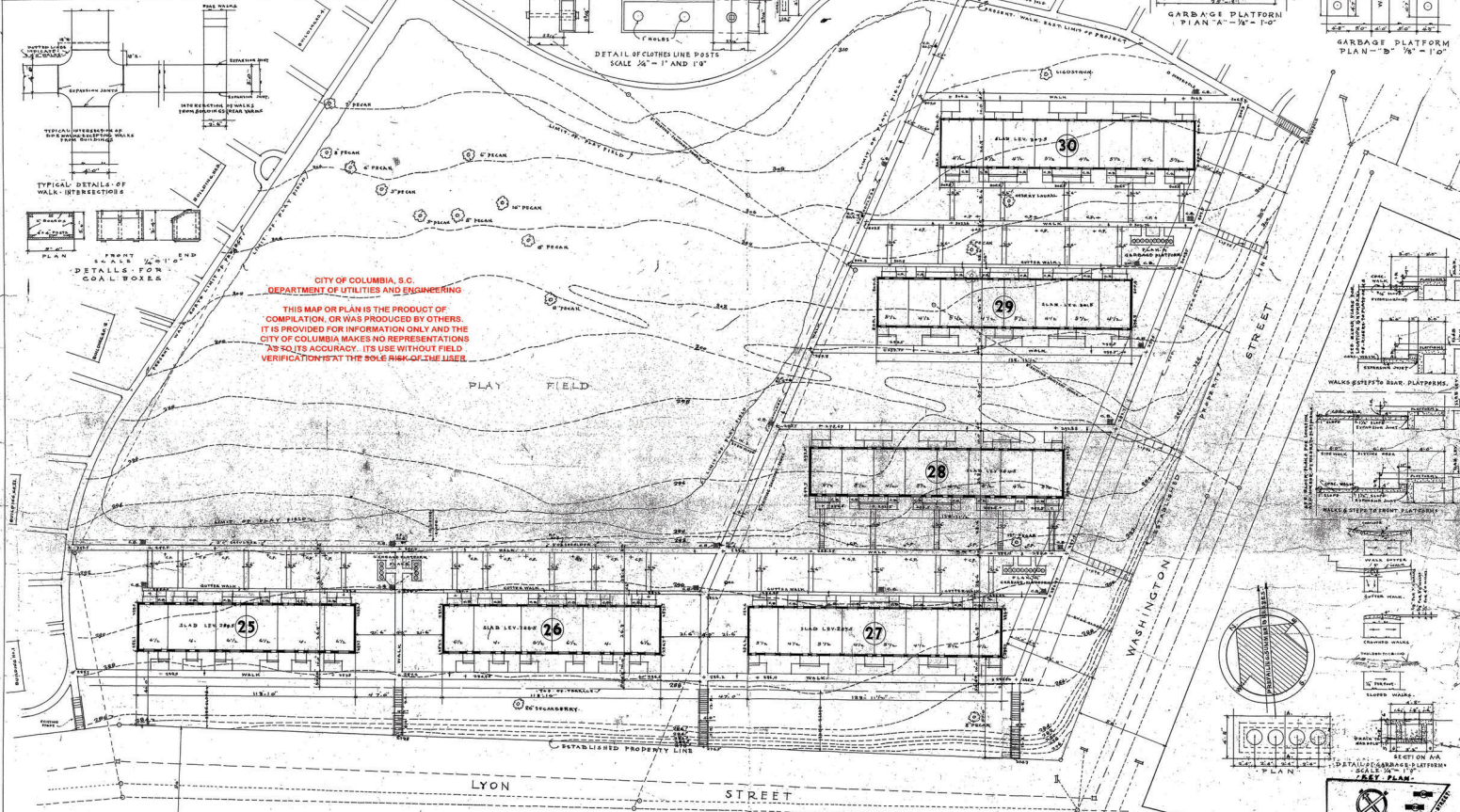

CITY OF COLUMBIA, S.C.
 DEPARTMENT OF UTILITIES AND ENGINEERING

THIS MAP OR PLAN IS THE PRODUCT OF COMPLETION, OR WAS PRODUCED BY OTHERS. IT IS PROVIDED FOR INFORMATION ONLY AND THE CITY OF COLUMBIA MAKES NO REPRESENTATIONS AS TO ITS ACCURACY. ITS USE WITHOUT FIELD VERIFICATION IS AT THE SOLE RISK OF THE USER.

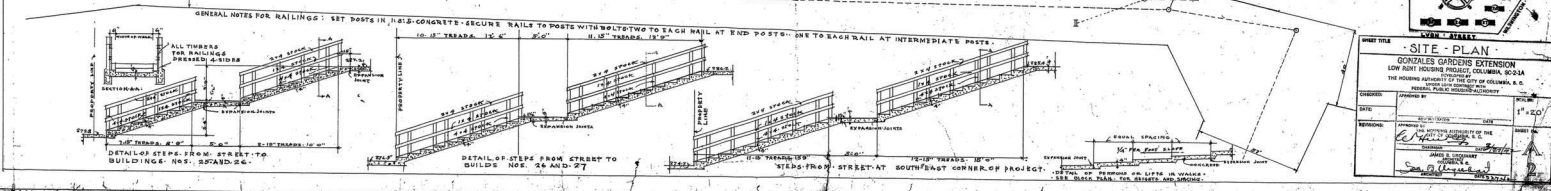

SITE PLAN
 GONZALES GARDENS EXTENSION
 LOW RENT HOUSING PROJECT, COLUMBIA, SOUTH CAROLINA

DATE: 11/1/50
 SCALE: 1" = 10'

DESIGNED BY: [Signature]
 CHECKED BY: [Signature]

Design of streets, driveways, paving, curbing and walls indicated for this site and shown on all sheets of this project of any one hereby approved by the City of Columbia, S.C.

D.S. [Signature]
 M.A. Thompson, Civil Engineer

26-24

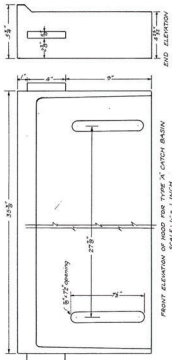
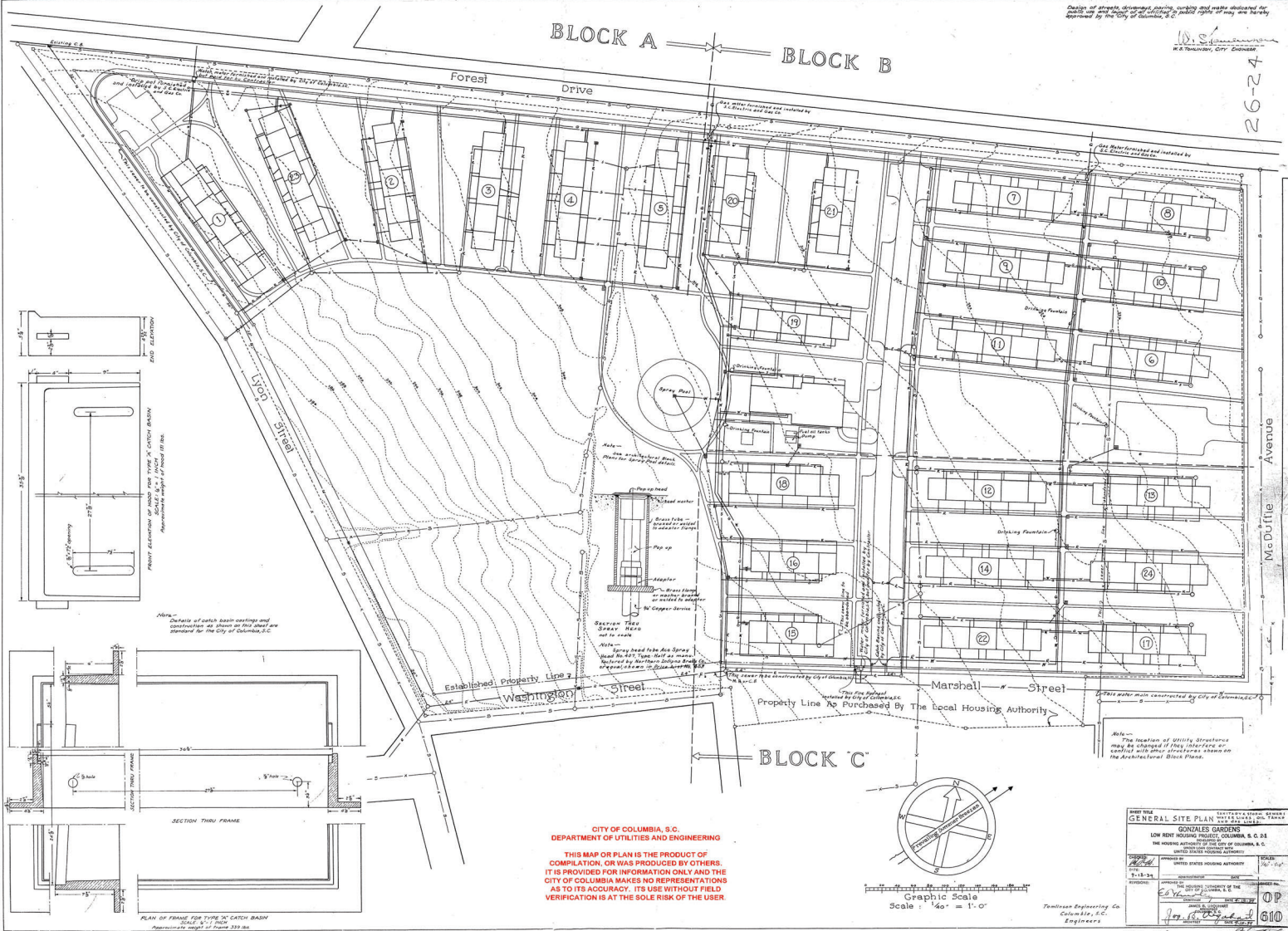

Notes: Details of catch basin castings and construction as shown on this sheet are standard for the City of Columbia, S.C.

PLAN OF FRAME FOR TYPE 'C' CATCH BASIN
 SCALE: 3/4" = 1'-0"
 Maximum Weight of Frame: 330 lbs.

CITY OF COLUMBIA, S.C.
 DEPARTMENT OF UTILITIES AND ENGINEERING

THIS MAP OR PLAN IS THE PRODUCT OF COMPILED, OR WAS PRODUCED BY OTHERS. IT IS PROVIDED FOR INFORMATION ONLY AND THE CITY OF COLUMBIA MAKES NO REPRESENTATIONS AS TO ITS ACCURACY. ITS USE WITHOUT FIELD VERIFICATION IS AT THE SOLE RISK OF THE USER.

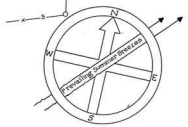

Graphic Scale
 Scale: 1/40" = 1'-0"

Note: The location of Utility Structures may be changed if they interfere or conflict with other structures shown on the Architectural Block Plans.

GENERAL SITE PLAN GONZALES GARDENS LOW RENT HOUSING PROJECT, COLUMBIA, S.C. 28		DATE: 1-18-34 SCALE: 1/40" = 1'-0"
DESIGNED BY: [Signature] DRAWN BY: [Signature]	CHECKED BY: [Signature] APPROVED BY: [Signature]	TITLE: OP NO.: 610

Pennington Engineering Co.
 Columbia, S.C.
 Engineers

26-24

Design of streets, drainage, paving curbing and walks indicated for public use and layout of all utilities of public right of way are hereby approved by the City of Columbia, S.C.

W.S. [Signature]
 U.S. [Signature]
 U.S. [Signature]

hb-9e

Forest Drive

of existing 20' concrete paving

Property line as purchased by the local Housing Authority

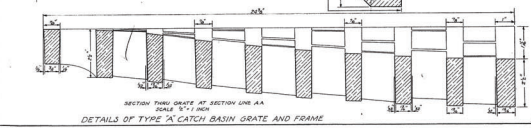
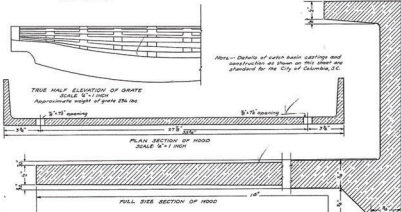
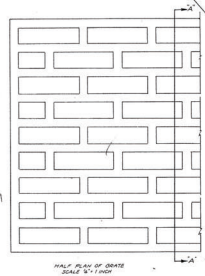
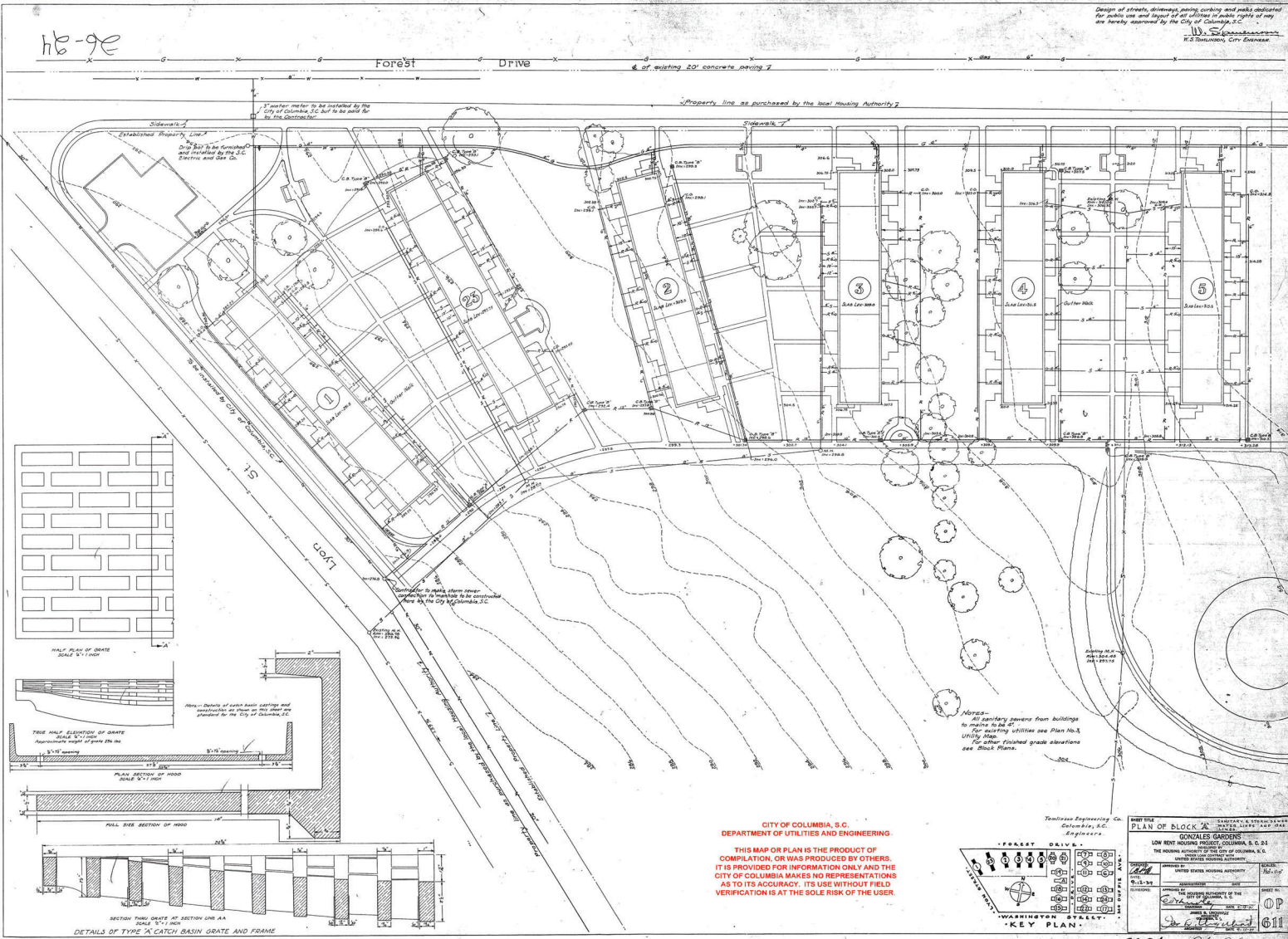

CITY OF COLUMBIA, S.C.
DEPARTMENT OF UTILITIES AND ENGINEERING

THIS MAP OR PLAN IS THE PRODUCT OF
 COMPILATION, OR WAS PRODUCED BY OTHERS.
 IT IS PROVIDED FOR INFORMATION ONLY AND THE
 CITY OF COLUMBIA MAKES NO REPRESENTATIONS
 AS TO ITS ACCURACY. ITS USE WITHOUT FIELD
 VERIFICATION IS AT THE SOLE RISK OF THE USER.

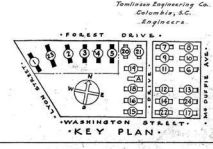

ENGINEER [Signature] U.S. [Signature]		ARCHITECT [Signature] U.S. [Signature]	
DATE: 11-15-59		SHEET NO.: 611	
PROJECT: GONZALES GARDENS LOW RENT HOUSING PROJECT, COLUMBIA, S.C. 291			

Design of streets, driveways, paving, curbing and walls dedicated for public use and layout of all utilities in public rights of way are hereby approved by the City of Columbia, S.C.
 H.S. Tolson, City Engineer.

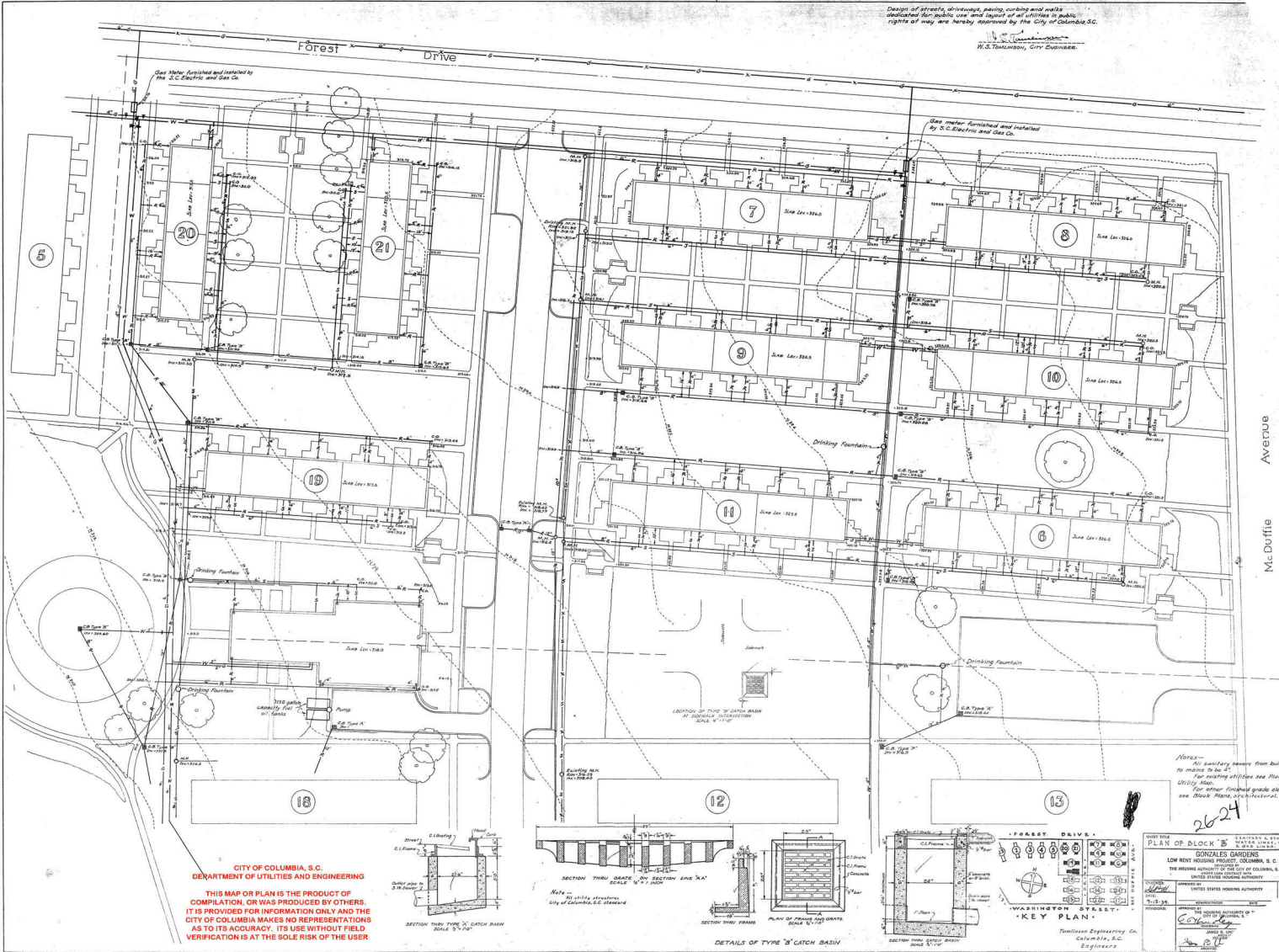

CITY OF COLUMBIA, S.C.
 DEPARTMENT OF UTILITIES AND ENGINEERING

THIS MAP OR PLAN IS THE PRODUCT OF COMPILATION, OR WAS PRODUCED BY OTHERS. IT IS PROVIDED FOR INFORMATION ONLY AND THE CITY OF COLUMBIA MAKES NO REPRESENTATIONS AS TO ITS ACCURACY. ITS USE WITHOUT FIELD VERIFICATION IS AT THE SOLE RISK OF THE USER.

Notes—
 All secondary mains from buildings to mains to be 4" for existing and 6" for new.
 For existing utilities see Plan No. 12, Utility Map.
 For other finished grade elevations see Block Plans architectural.

2624

PLAN OF BLOCK 'B' GONZALES GARDENS
 LOW RENT HOUSING PROJECT, COLUMBIA, S. C. 24
 THE POWER AUTHORITY OF THE CITY OF COLUMBIA, S. C.
 UNITED STATES HOUSING AUTHORITY

WASHINGTON STREET ENGINEERS
 Columbia, S. C.

**CITY OF COLUMBIA, S.C.
DEPARTMENT OF UTILITIES AND ENGINEERING**

**THIS MAP OR PLAN IS THE PRODUCT OF
COMPILATION, OR WAS PRODUCED BY OTHERS.
IT IS PROVIDED FOR INFORMATION ONLY AND THE
CITY OF COLUMBIA MAKES NO REPRESENTATIONS
AS TO ITS ACCURACY. ITS USE WITHOUT FIELD
VERIFICATION IS AT THE SOLE RISK OF THE USER.**

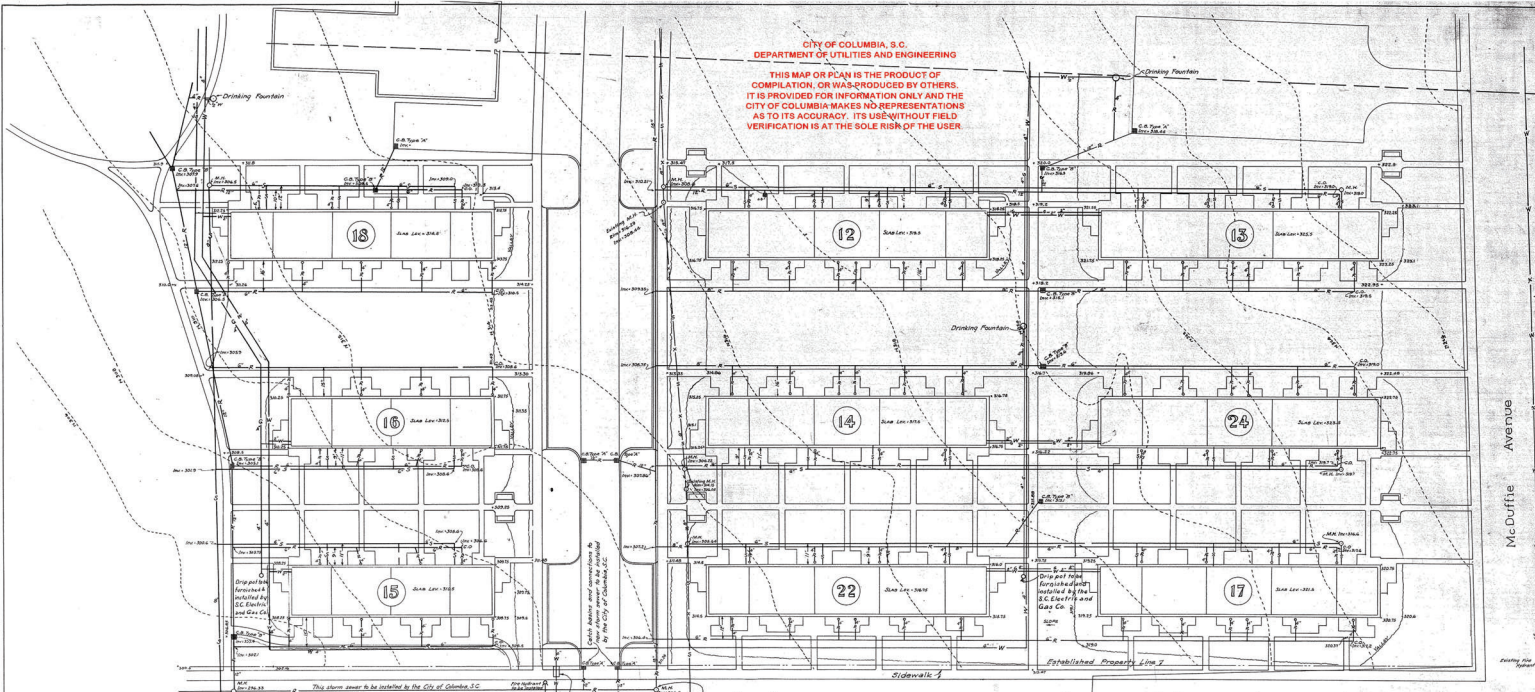

Washington Street
Contractor to connect storm sewer to manhole to be constructed by the City of Columbia, S.C. at this point.

Water Meter to be installed by the City of Columbia, S.C. but paid for by the Contractor.

Contractor to connect storm sewer to manhole to be constructed by the City of Columbia, S.C. at this point.

Marshall Street
The water main to be installed by the City of Columbia, S.C.

Notes
All sanitary sewers from buildings to mains to be 4".
For sanitary utilities see Plans No. 1, 2, 3, 4, 5, 6, 7, 8, 9, 10, 11, 12, 13, 14, 15, 16, 17, 18, 19, 20, 21, 22, 23, 24, 25, 26, 27, 28, 29, 30, 31, 32, 33, 34, 35, 36, 37, 38, 39, 40, 41, 42, 43, 44, 45, 46, 47, 48, 49, 50, 51, 52, 53, 54, 55, 56, 57, 58, 59, 60, 61, 62, 63, 64, 65, 66, 67, 68, 69, 70, 71, 72, 73, 74, 75, 76, 77, 78, 79, 80, 81, 82, 83, 84, 85, 86, 87, 88, 89, 90, 91, 92, 93, 94, 95, 96, 97, 98, 99, 100.
For other finished grade elevations see Block Plans.
Design of streets, sidewalks, paving, curbing and walks dedicated for public use and layout of all utilities in public rights of way are hereby approved by the City of Columbia, S.C.
R.S. SULLIVAN, City Engineer

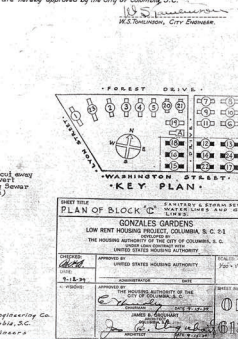
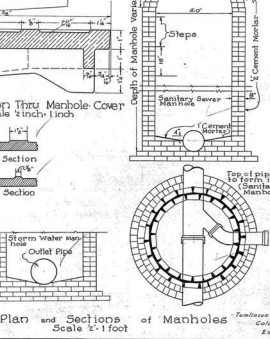
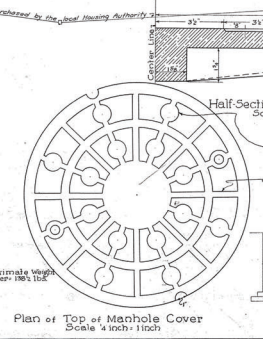
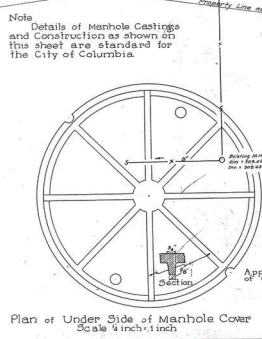
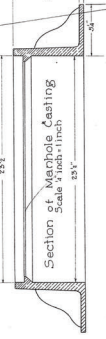
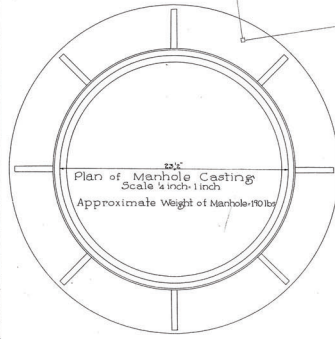

Note: Details of Manhole Castings and Construction as shown on this sheet are standard for the City of Columbia.

Property Line as purchased by the Real Estate Authority.

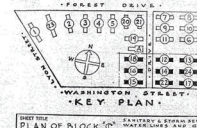

THIS IS THE PLAN OF BLOCK 'C'...
DONALD S. GARDNER
LOW RENT HOUSING PROJECT, COLUMBIA, S.C. #1
THE ENGINEER OF THE CITY OF COLUMBIA, S.C.
COLUMBIA, S.C. 29201

66-68

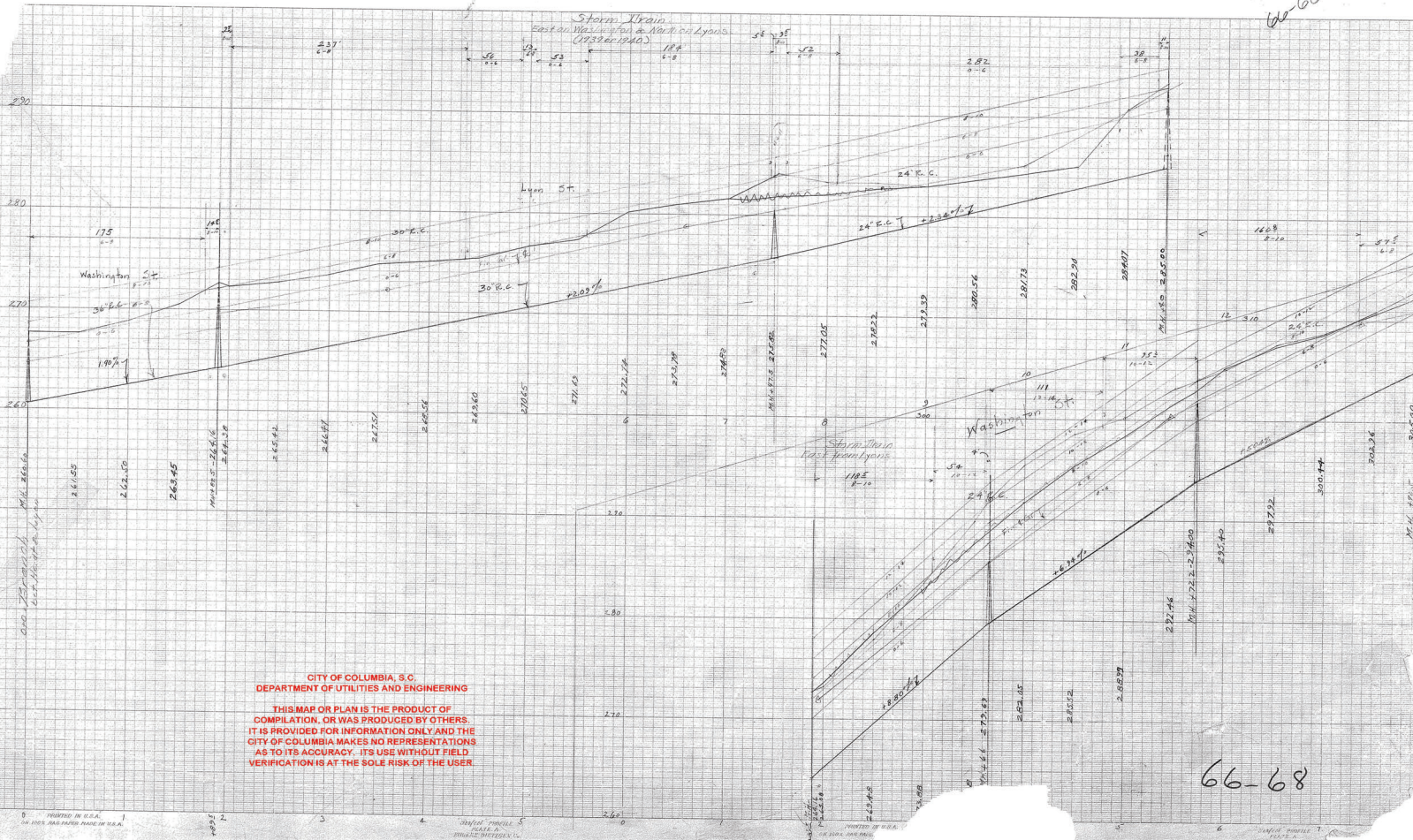

CITY OF COLUMBIA, S.C.
 DEPARTMENT OF UTILITIES AND ENGINEERING

THIS MAP OR PLAN IS THE PRODUCT OF
 COMPILATION, OR WAS PRODUCED BY OTHERS.
 IT IS PROVIDED FOR INFORMATION ONLY AND THE
 CITY OF COLUMBIA MAKES NO REPRESENTATIONS
 AS TO ITS ACCURACY. ITS USE WITHOUT FIELD
 VERIFICATION IS AT THE SOLE RISK OF THE USER.

66-68

CITY OF COLUMBIA, S.C.
DEPARTMENT OF UTILITIES AND ENGINEERING

THIS MAP OR PLAN IS THE PRODUCT OF
COMPILATION, OR WAS PRODUCED BY OTHERS.
IT IS PROVIDED FOR INFORMATION ONLY AND THE
CITY OF COLUMBIA MAKES NO REPRESENTATIONS
AS TO ITS ACCURACY. ITS USE WITHOUT FIELD
VERIFICATION IS AT THE SOLE RISK OF THE USER.



NOTE—SEE SHEET 3 FOR DETAIL OF TRENHOLM ROAD

NOTE—SEE SHEET 9 FOR DETAIL OF MILLWOOD AVE

DEPARTMENT OF ENGINEERING, CITY OF COLUMBIA, S. C.		
SANITARY SEWER SYSTEM PROJECT 923-B SECTION I		
LAYOUT		
SCALE 1/4" = 300'	DATE 3/5/34	INDEX
W. S. [Signature] CITY ENGINEER		

SCANNED

SHEET 2 OF 17

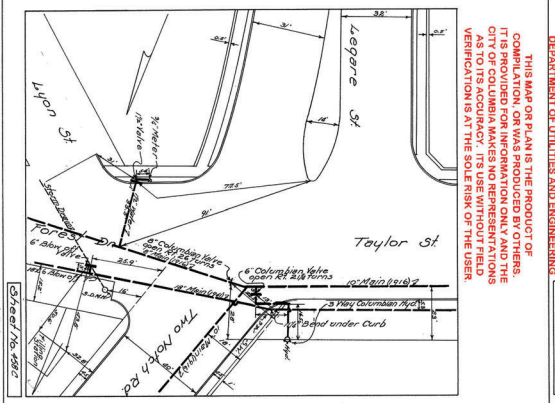
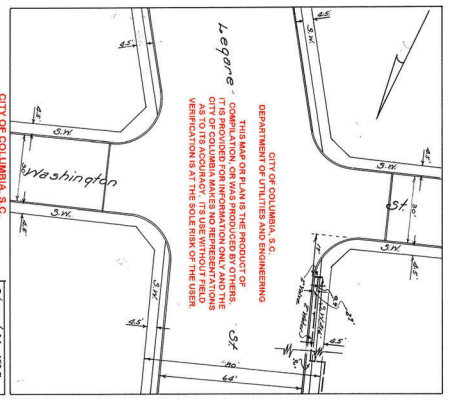
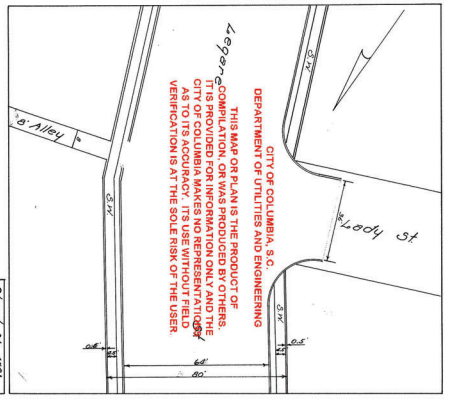

CITY OF COLUMBIA, S.C.
DEPARTMENT OF UTILITIES AND ENGINEERING

THIS MAP OR PLAN IS THE PRODUCT OF
COMPILATION, OR WAS PRODUCED BY OTHERS.
IT IS PROVIDED FOR INFORMATION ONLY AND THE
CITY OF COLUMBIA MAKES NO REPRESENTATIONS
AS TO ITS ACCURACY. ITS USE WITHOUT FIELD
VERIFICATION IS AT THE SOLE RISK OF THE USER.

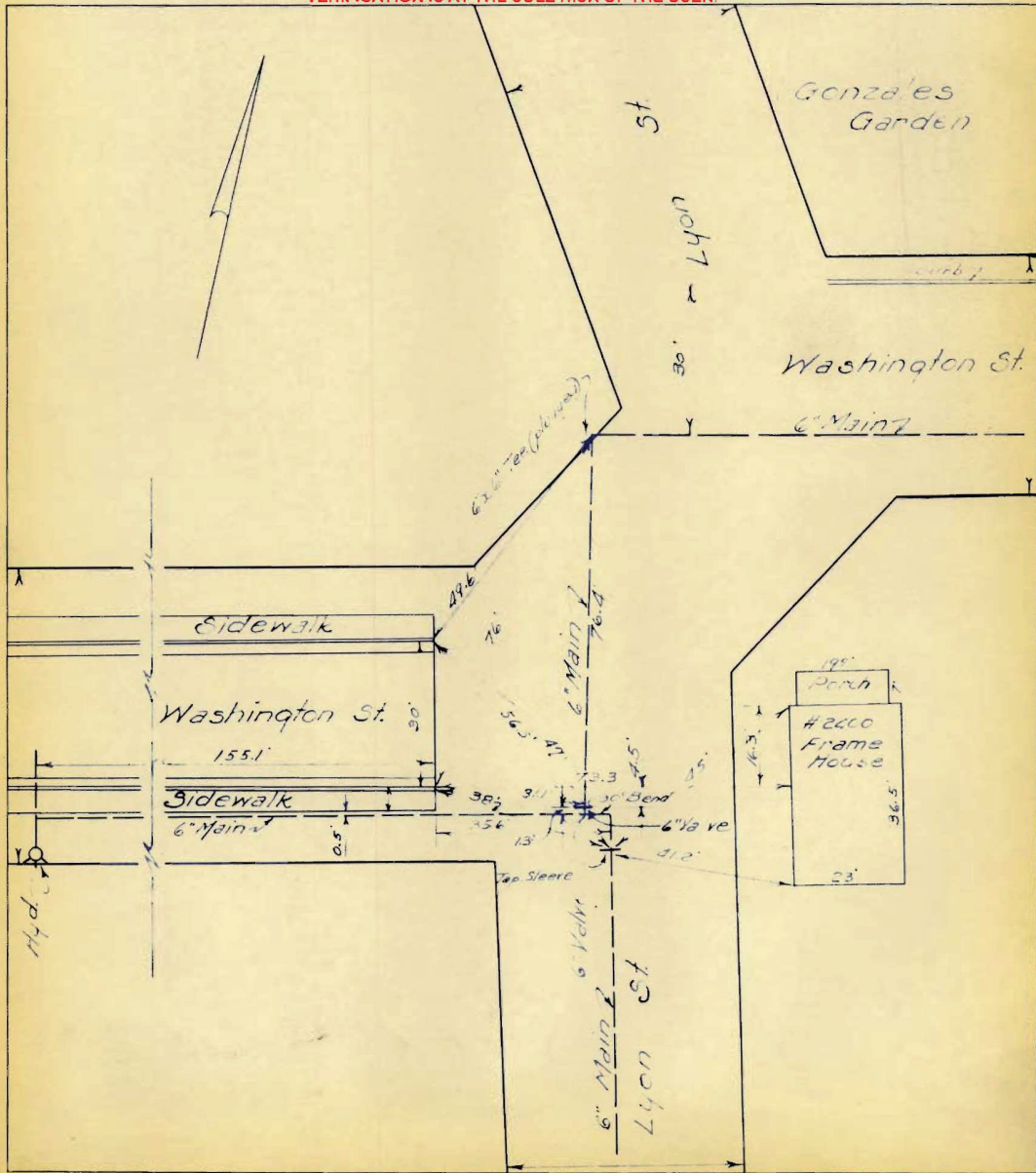

Sheet No. 97

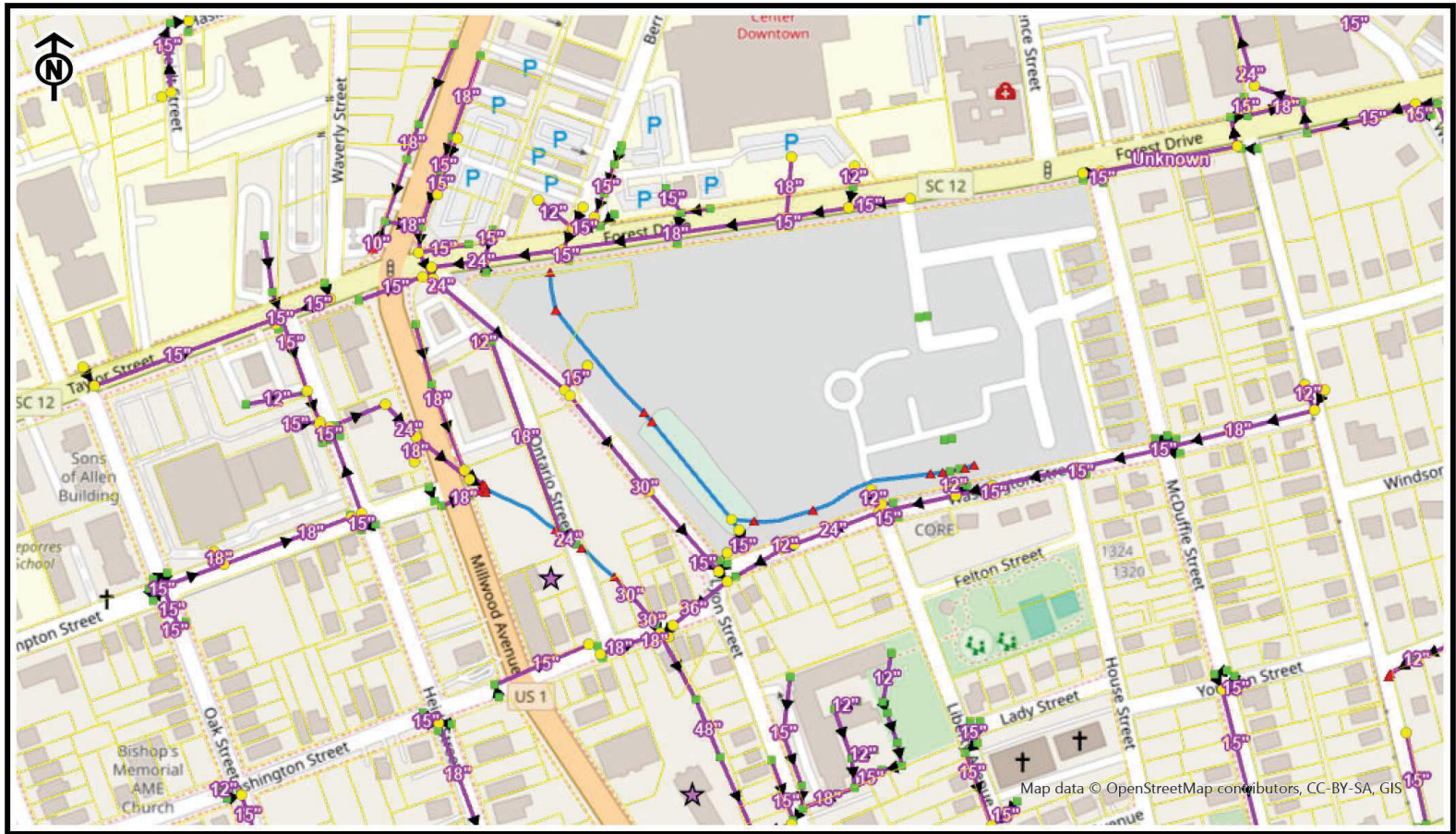

City of Columbia

This map was prepared using the City GIS Viewer

City of Columbia - GIS Division

6/6/2024 6:40 AM



- Tax Parcel
- Natural Waterbody
- Perm BMP
- Open Drain

Abandoned or Proposed Drainpipe

Life Cycle Status

- Abandoned
- Proposed

Drainpipe

Integration Status

- Integrated
- Not Integrated
- Inlet
- Network Structure
- Discharge Point
- Industrial Sites MS4



CITY OF COLUMBIA GIS DATA DISCLAIMER:

The City of Columbia GIS data represented on this map or plan is the product of the compilation of data produced by others. It is provided for informational purposes only and the City of Columbia makes no representation as to its accuracy. Its use without field verification is at the sole risk of the user.

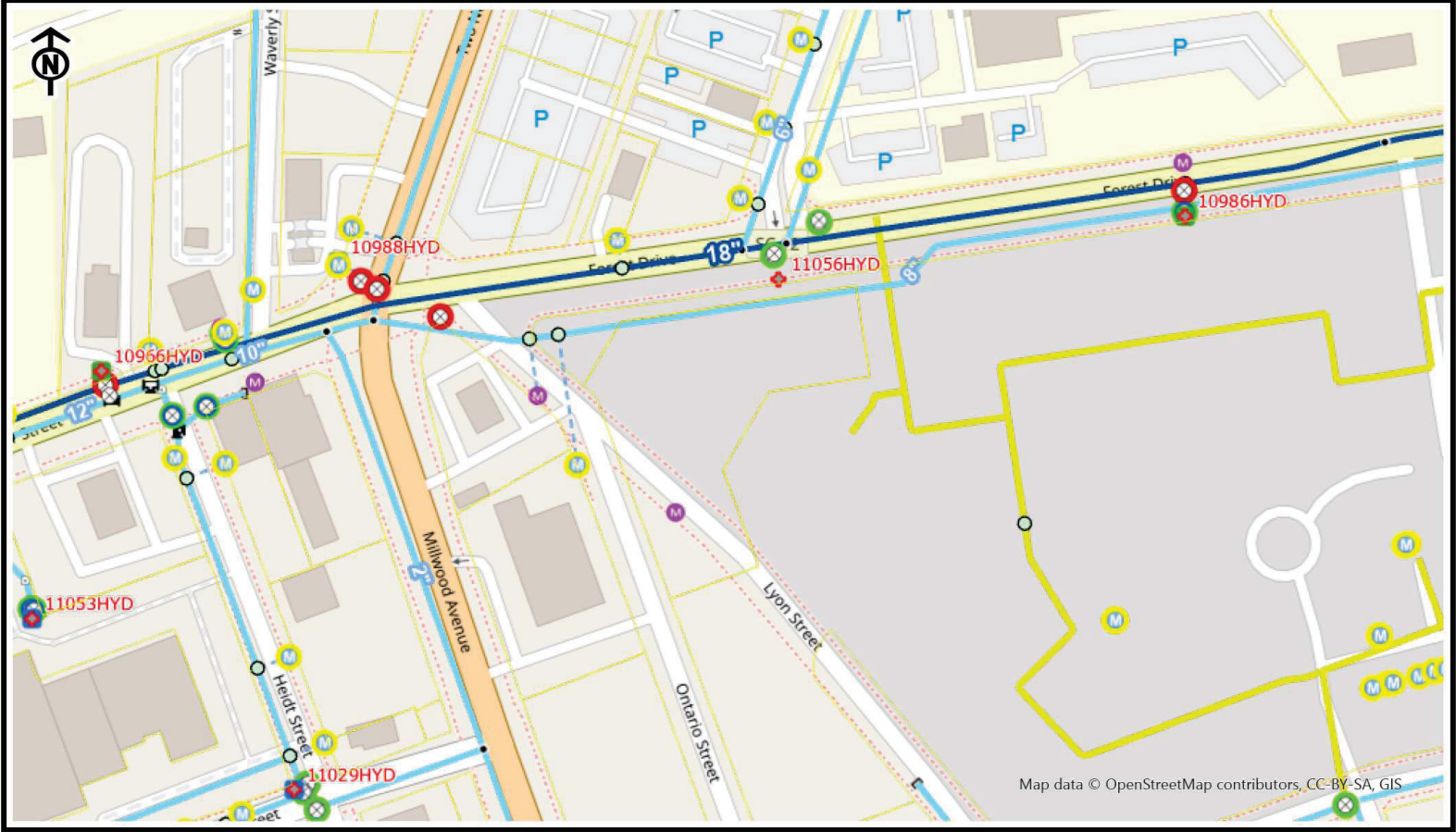

City of Columbia

This map was prepared using the City GIS Viewer

City of Columbia - GIS Division

6/6/2024 6:33 AM



- | | | | |
|--|---|--|--|
| <ul style="list-style-type: none"> Tax Parcel WM4484 VALVES ● Located ○ Not Located ○ Not Located ○ Not Located ○ Not Located Water Meter (Inactive/Outbook) ○ InActive ○ Outbook --- Water Service Line (Active) Water Main (Abandoned or Proposed) --- Abandoned --- Proposed | <ul style="list-style-type: none"> Water Fitting (Active) ● Tapping Sleeve & Valve ○ Tap ○ Bend ○ Cap ○ Cross ○ Reducer ✦ Reducing Cross ✦ Reducing Tee Sleeve ⊕ Tee ⊕ Wye • Unknown Water System Valve (Active) ○ Survey Grade GPS | <ul style="list-style-type: none"> ○ Other Datasource Water Main (Active) --- Distribution --- Transmission --- Water Control Valve (Active) Hydrant (Active) ● CDC (Active, No Flow Band) ● CDC (Active, Blue Flow Band) ● CDC (Active, Green Flow Band) ● CDC (Active, Yellow Flow Band) ○ Inactive (All) ○ Inactive (All) ○ Inactive (All) ○ Inactive (All) ○ Inactive (All) ○ Inactive (All) | <ul style="list-style-type: none"> ● Private (Active) ● Private (Active) ● Private (Active) ● Private (Active) ● Private (Active) Water Meter (Active) ○ Analog ○ City - Digital ○ LIMS - Digital ○ PRV (Active) □ Pump Station (Active) Tank (Active) ✦ Tank - Elevated |
|--|---|--|--|

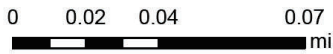

**CITY OF COLUMBIA
GIS DATA DISCLAIMER:**
The City of Columbia GIS data represented on this map or plan is the product of the compilation of data produced by others. It is provided for informational purposes only and the City of Columbia makes no representation as to its accuracy. Its use without field verification is at the sole risk of the user.

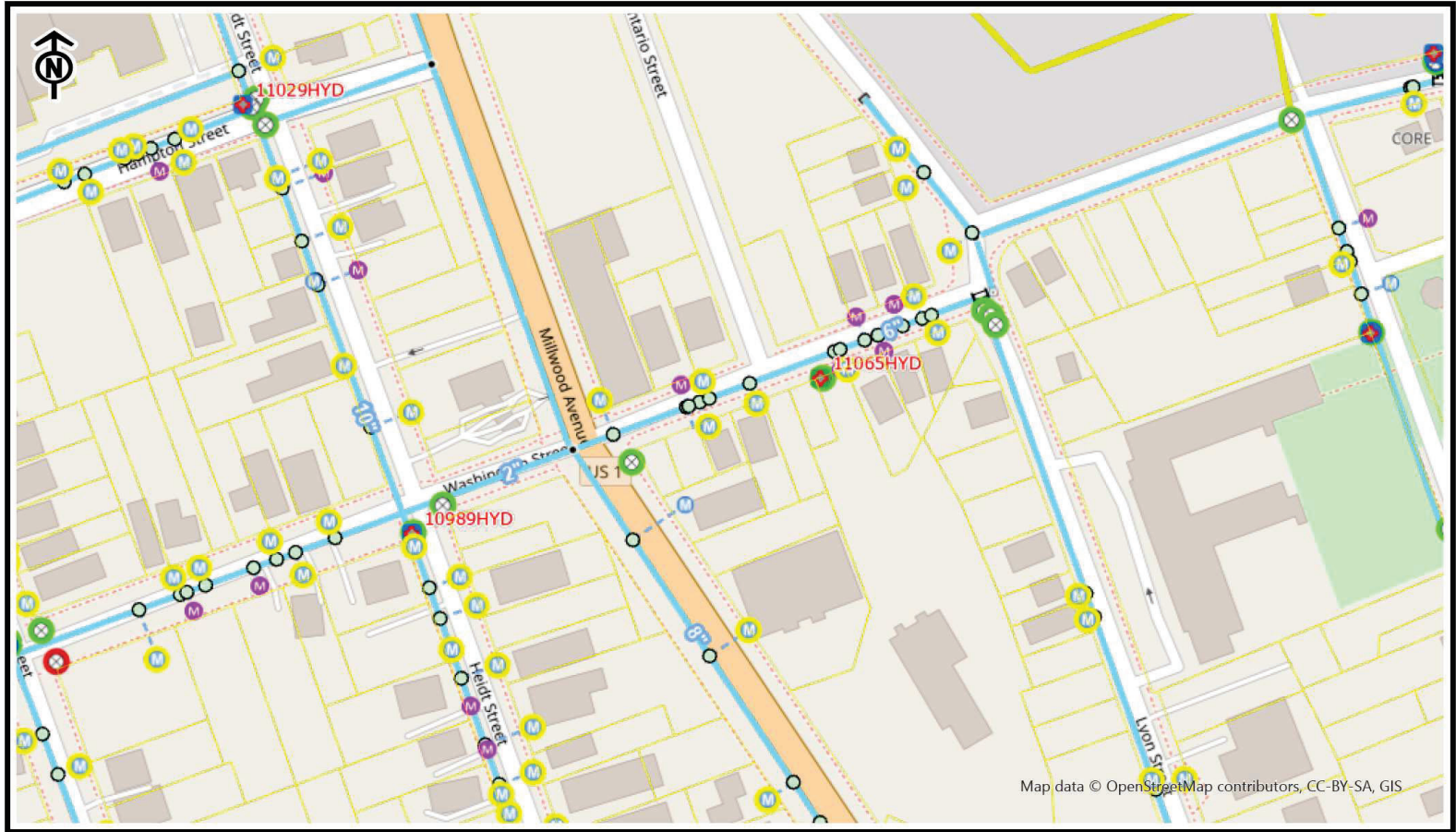

Map data © OpenStreetMap contributors, CC-BY-SA, GIS

City of Columbia

This map was prepared using the City GIS Viewer

City of Columbia - GIS Division

6/6/2024 6:34 AM



- | | | | |
|---|--|--|---|
| <ul style="list-style-type: none"> □ Tax Parcel WM4484 VALVES ● Located ○ Not Located ○ Not Located ○ Not Located ○ Not Located ○ InActive ○ Outbook --- Water Service Line (Active) Water Main (Abandoned or Proposed) --- Abandoned --- Proposed | <ul style="list-style-type: none"> Water Fitting (Active) ● Tapping Sleeve & Valve ○ Tap ○ Bend ○ Sleeve ○ Cap ○ Cross ○ Reducer ● Reducing Cross ● Reducing Tee ○ Sleeve ○ Tee ○ Wye ● Unknown Water System Valve (Active) ○ Survey Grade GPS | <ul style="list-style-type: none"> ○ Other Datasource Water Main (Active) --- Distribution --- Transmission --- Water Control Valve (Active) Hydrant (Active) ● CDC (Active, No Flow Band) ● CDC (Active, Blue Flow Band) ● CDC (Active, Green Flow Band) ● CDC (Active, Yellow Flow Band) ○ Inactive (All) ○ Inactive (All) ○ Inactive (All) ○ Inactive (All) ○ Inactive (All) ○ Inactive (All) ○ Inactive (All) ○ Inactive (All) | <ul style="list-style-type: none"> ● Private (Active) ● Private (Active) ● Private (Active) ● Private (Active) ● Private (Active) Water Meter (Active) ○ Analog ○ City - Digital ○ LIMS - Digital ○ PRV (Active) ○ Pump Station (Active) Tank (Active) ● Tank - Elevated |
|---|--|--|---|



CITY OF COLUMBIA GIS DATA DISCLAIMER:
 The City of Columbia GIS data represented on this map or plan is the product of the compilation of data produced by others. It is provided for informational purposes only and the City of Columbia makes no representation as to its accuracy. Its use without field verification is at the sole risk of the user.

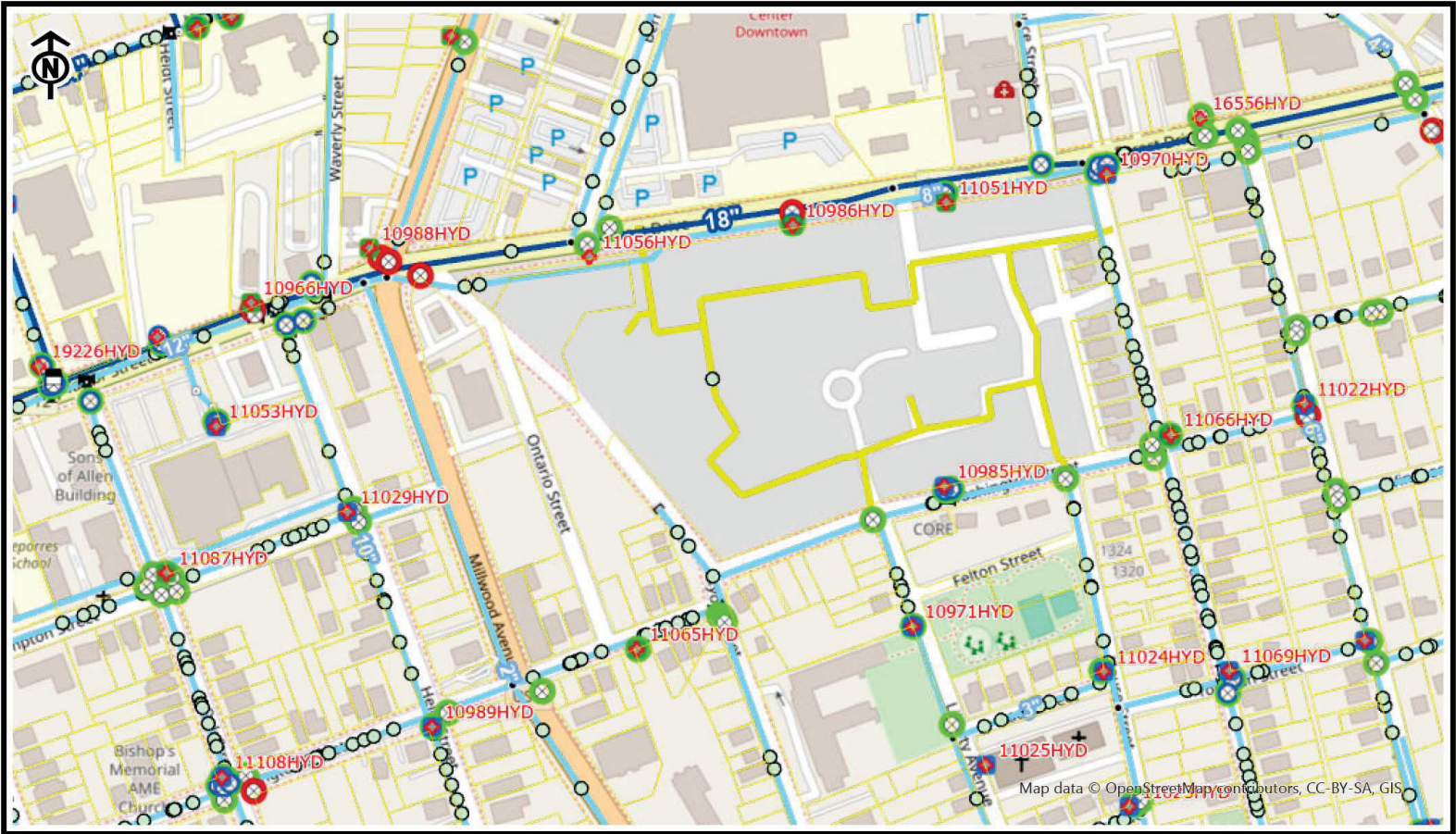

City of Columbia

This map was prepared using the City GIS Viewer

City of Columbia - GIS Division

6/6/2024 6:39 AM



- | | | | |
|--|--|--|---|
| <ul style="list-style-type: none"> □ Tax Parcel WM4484 VALVES ○ Located ○ Not Located ○ Not Located ○ Not Located Water Main (Abandoned or Proposed) — Abandoned — Proposed Water Fitting (Active) ○ Tapping Sleeve & Valve ○ Tap ○ Bend | <ul style="list-style-type: none"> □ Cap □ Cross ✕ Reducer ✕ Reducing Cross ✕ Reducing Tee □ Sleeve □ Tee • Wye • Unknown Water System Valve (Active) ○ Survey Grade GPS ○ Other Datasource Water Main (Active) — Distribution | <ul style="list-style-type: none"> — Transmission — Water Control Valve (Active) Hydrant (Active) ◆ COC (Active, No Flow Band) ◆ COC (Active, Blue Flow Band) ◆ COC (Active, Green Flow Band) ◆ COC (Active, Yellow Flow Band) ◆ Inactive (All) ◆ Inactive (All) ◆ Inactive (All) ◆ Inactive (All) ◆ Private (Active) ◆ Private (Active) | <ul style="list-style-type: none"> ◆ Private (Active) ◆ Private (Active) ○ PRV (Active) □ Pump Station (Active) Tank (Active) ✕ Tank - Elevated ○ Tank - Standpipe □ Water Treatment Plant ★ Water District Offices |
|--|--|--|---|



**CITY OF COLUMBIA
GIS DATA DISCLAIMER:**
The City of Columbia GIS data represented on this map or plan is the product of the compilation of data produced by others. It is provided for informational purposes only and the City of Columbia makes no representation as to its accuracy. Its use without field verification is at the sole risk of the user.